

ELECTORAL ROLL 2024 S16 Mizoram

No. Name and Reservation Status of Assembly Constituency : 10 - AIZAWL NORTH I (ST)		Part No. : 1															
No. Name and Reservation Status of Parliamentary Constituency(ies) in which the Assembly Constituency is located : 1 - MIZORAM (ST)																	
1. Details of Revision																	
Year of Revision	2024	Roll Identification															
Qualifying Date	01-01-2024	Basic Roll of Intensive Revision, 2005 integrated with all supplements of Special Summary Revision, 2024															
Type of revision	Special Summary Revision 2024																
Date of Publication	08-02-2024																
2. Details of part and polling area																	
No. and name of sections in the part																	
1-Selesih, Vengpui 2-Selesih, Venghlun		<table style="width: 100%; border-collapse: collapse;"> <tr> <td style="width: 60%;">Main Town or Village</td> <td>: AIZAWL</td> </tr> <tr> <td>Post Office</td> <td>: DURTLANG</td> </tr> <tr> <td>Police Station</td> <td>: BAWNGKAWN</td> </tr> <tr> <td>Block</td> <td>: TLANGNUAM</td> </tr> <tr> <td>Subdivision</td> <td>: AIZAWL SADAR</td> </tr> <tr> <td>District</td> <td>: AIZAWL</td> </tr> <tr> <td>Pin code</td> <td>: 796015</td> </tr> </table>		Main Town or Village	: AIZAWL	Post Office	: DURTLANG	Police Station	: BAWNGKAWN	Block	: TLANGNUAM	Subdivision	: AIZAWL SADAR	District	: AIZAWL	Pin code	: 796015
Main Town or Village	: AIZAWL																
Post Office	: DURTLANG																
Police Station	: BAWNGKAWN																
Block	: TLANGNUAM																
Subdivision	: AIZAWL SADAR																
District	: AIZAWL																
Pin code	: 796015																
3. Polling station details																	
No. and Name of Polling Station :		Type of Polling Station (Male/Female/General)	General														
1 - SELESIH		Number of Auxiliary Polling Stations in this part :	0														
Address of Polling Station :																	
Govt. Middle School, ROOM NO - 1																	
4. NUMBER OF ELECTORS																	
Starting	Ending	Net Electors															
Serial No.	Serial No.	Male	Female	Third Gender	Total												
1	670	324	344	0	668												

Signature of Electoral Registration Officer

Nazri Naksha

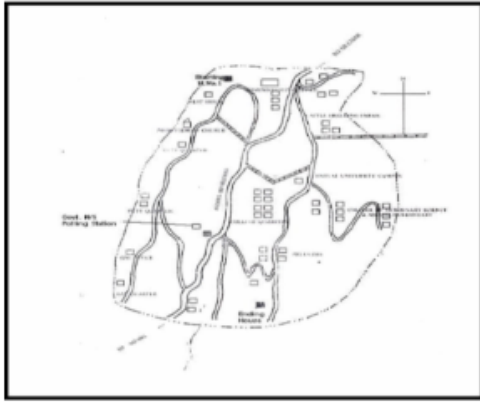

Google Map View



Polling Station Building Front View



Polling Station Front View



CAD View

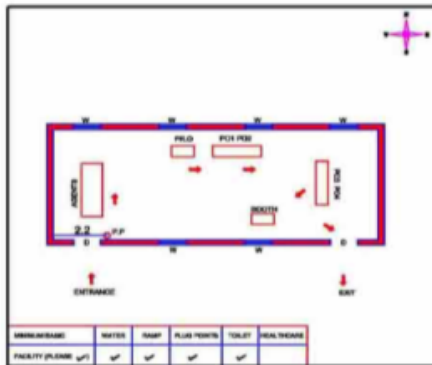

Key Map View

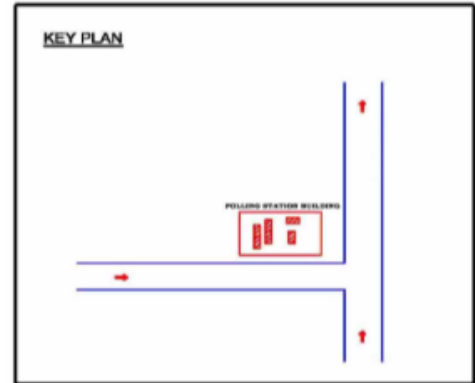

<p>1</p> <p>Name : Lalkhuma Father's Name : Zakamlova (L) House Number (Notional) : 1 Age : 85 Gender : Male</p> <p>Photo Available</p>	LXK0056432	<p>2</p> <p>Name : H. Lalruatkima Father's Name : Lalkhuma House Number (Notional) : 1 Age : 53 Gender : Male</p> <p>Photo Available</p>	LXK0055707	<p>3</p> <p>Name : Lalrinthangi Father's Name : Lalkhuma House Number (Notional) : 1 Age : 45 Gender : Female</p> <p>Photo Available</p>	LXK0056523
<p>4</p> <p>Name : Vanrammawia Royte Father's Name : Lalkhuma House Number (Notional) : 1 Age : 41 Gender : Male</p> <p>Photo Available</p>	LXK0042341	<p>5</p> <p>Name : B. Laingaisaki Husband's Name : Vanrammawia Royte House Number (Notional) : 1 Age : 40 Gender : Female</p> <p>Photo Available</p>	TYI0036657	<p>6</p> <p>Name : Lallawmsangi Father's Name : Lalkhuma House Number (Notional) : 1 Age : 40 Gender : Female</p> <p>Photo Available</p>	LXK0042358
<p>7</p> <p>Name : Lalhriatpuia Father's Name : H. Lalruatkima House Number (Notional) : 1 Age : 27 Gender : Male</p> <p>Photo Available</p>	RHE0052936	<p>8</p> <p>Name : Ramfangzauva Royte Father's Name : Lalkhuma House Number (Notional) : 2 Age : 50 Gender : Male</p> <p>Photo Available</p>	LXK0042366	<p>9</p> <p>Name : Zonunpari Husband's Name : Ramfangzauva Royte House Number (Notional) : 2 Age : 44 Gender : Female</p> <p>Photo Available</p>	LXK0053801
<p>10</p> <p>Name : H. Lalingaihawma Father's Name : Lalkhuma House Number (Notional) : 3 Age : 45 Gender : Male</p> <p>Photo Available</p>	LXK0039693	<p>11</p> <p>Name : R. K. Lalfakawmi Husband's Name : H. Lalingaihawma House Number (Notional) : 3 Age : 43 Gender : Female</p> <p>Photo Available</p>	JFK0119594	<p>12</p> <p>Name : Lalremthangi Father's Name : Lianphaia (L) House Number (Notional) : 4 Age : 57 Gender : Female</p> <p>Photo Available</p>	LXK0056440
<p>13</p> <p>Name : R. Lalhmingzuali Father's Name : Ramhmuzauva House Number (Notional) : 4 Age : 32 Gender : Female</p> <p>Photo Available</p>	RHE0024208	<p>14</p> <p>Name : Lalrintluanga Kawlni Father's Name : Ramhmuzauva House Number (Notional) : 4 Age : 29 Gender : Male</p> <p>Photo Available</p>	LXK0255679	<p>15</p> <p>Name : Vanlalmuana Father's Name : H. D. Zawla House Number (Notional) : 5 Age : 61 Gender : Male</p> <p>Photo Available</p>	LXK0057489
<p>16</p> <p>Name : Lalrinpuia Husband's Name : Vanlalmuana House Number (Notional) : 5 Age : 56 Gender : Female</p> <p>Photo Available</p>	LXK0057059	<p>17</p> <p>Name : H. S. Lalsangliana Father's Name : Vanlalmuana House Number (Notional) : 5 Age : 47 Gender : Male</p> <p>Photo Available</p>	LXK0055053	<p>18</p> <p>Name : Jenny. Lalsangkimi Father's Name : H. D. Vanlalmuana House Number (Notional) : 5 Age : 41 Gender : Female</p> <p>Photo Available</p>	LXK0057182
<p>19</p> <p>Name : H. Lalinunpuia Father's Name : H. D. Vanlalmuana House Number (Notional) : 5 Age : 36 Gender : Male</p> <p>Photo Available</p>	LXK0057091	<p>20</p> <p>Name : Rinmuanpuia Father's Name : H. Lalinunpuia House Number (Notional) : 5 Age : 22 Gender : Female</p> <p>Photo Available</p>	RHE0086355	<p>21</p> <p>Name : H. Lalbiakzuala Father's Name : H. Lalinunpuia House Number (Notional) : 5 Age : 20 Gender : Male</p> <p>Photo Available</p>	RHE0102053
<p>22</p> <p>Name : Beener Lalramthara Father's Name : H. D. Vanlalmuana House Number (Notional) : 6 Age : 37 Gender : Male</p> <p>Photo Available</p>	LXK0213256	<p>23</p> <p>Name : H. S. Zoremsanga Father's Name : Rinsanga House Number (Notional) : 7 Age : 31 Gender : Male</p> <p>Photo Available</p>	RHE0007294	<p>24</p> <p>Name : Lalremkimi Father's Name : Shillongthanga House Number (Notional) : 7 Age : 28 Gender : Female</p> <p>Photo Available</p>	RHE0062356
<p>25</p> <p>Name : Kawlengmawia Father's Name : Lianvela House Number (Notional) : 8 Age : 48 Gender : Male</p> <p>Photo Available</p>	LFL0239228	<p>26</p> <p>Name : Laltlanmawii Husband's Name : H. Lalruatkima House Number (Notional) : 8 Age : 42 Gender : Female</p> <p>Photo Available</p>	LXK0057265	<p>27</p> <p>Name : Lianenga Father's Name : V. Lalduta House Number (Notional) : 9 Age : 65 Gender : Male</p> <p>Photo Available</p>	LXK0057273
<p>E 28</p> <p>Name : Laldusangi Husband's Name : Lianenga House Number (Notional) : 9 Age : 65 Gender : Female</p> <p>Photo Available</p>	LXK0057240	<p>29</p> <p>Name : Vanlalzuaia Father's Name : Lianenga House Number (Notional) : 9 Age : 47 Gender : Male</p> <p>Photo Available</p>	LXK0055343	<p>30</p> <p>Name : Lalthlamuani Husband's Name : K. Lalawmpuia House Number (Notional) : 9 Age : 44 Gender : Female</p> <p>Photo Available</p>	LXK0057232

<p>31</p> <p>RHE0102061</p> <p>Name : Remruatpui Father's Name : Lalchhanhima House Number (Notional) : 9 Age : 20 Gender : Female</p> <p>Photo Available</p>	<p>32</p> <p>JDF0142919</p> <p>Name : Vanlalfeia Father's Name : Saihnuna House Number (Notional) : 10 Age : 60 Gender : Male</p> <p>Photo Available</p>	<p>33</p> <p>JDF0143404</p> <p>Name : Vanlalhumi Husband's Name : Vanlalfeia House Number (Notional) : 10 Age : 53 Gender : Female</p> <p>Photo Available</p>
<p>34</p> <p>RHE0011734</p> <p>Name : Laiedenthari Father's Name : Vanlalfeia House Number (Notional) : 10 Age : 33 Gender : Female</p> <p>Photo Available</p>	<p>35</p> <p>RHE0052944</p> <p>Name : Lallawmpuia Father's Name : Lalfeia House Number (Notional) : 10 Age : 27 Gender : Male</p> <p>Photo Available</p>	<p>36</p> <p>RHE0070847</p> <p>Name : Vantharngaki Father's Name : Lalfeia House Number (Notional) : 10 Age : 24 Gender : Female</p> <p>Photo Available</p>
<p>37</p> <p>RHE0102038</p> <p>Name : Lalruatmawii Father's Name : V. Lalfeia House Number (Notional) : 10 Age : 20 Gender : Female</p> <p>Photo Available</p>	<p>38</p> <p>RHE0078774</p> <p>Name : Vanlalhlani Husband's Name : Vanthuama House Number (Notional) : 11 Age : 60 Gender : Female</p> <p>Photo Available</p>	<p>39</p> <p>TXB0035493</p> <p>Name : T Lalrintluanga Father's Name : Vanthuama House Number (Notional) : 11 Age : 32 Gender : Male</p> <p>Photo Available</p>
<p>40</p> <p>TXB0035501</p> <p>Name : Lalthazama Father's Name : Vanthuama House Number (Notional) : 11 Age : 30 Gender : Male</p> <p>Photo Available</p>	<p>41</p> <p>TXB0045500</p> <p>Name : Vanlalmuangpua Father's Name : Vanthuama House Number (Notional) : 11 Age : 28 Gender : Male</p> <p>Photo Available</p>	<p>42</p> <p>LXK0057331</p> <p>Name : Lalbiakvelli Husband's Name : Vanhnuailiana House Number (Notional) : 12 Age : 59 Gender : Female</p> <p>Photo Available</p>
<p>43</p> <p>RHE0020354</p> <p>Name : Rosie Malsawmtluangi Father's Name : Vanhnuailiana House Number (Notional) : 12 Age : 32 Gender : Female</p> <p>Photo Available</p>	<p>44</p> <p>LXK0213249</p> <p>Name : R. Lalduhawma Father's Name : Vanhnuailiana House Number (Notional) : 12 Age : 32 Gender : Male</p> <p>Photo Available</p>	<p>45</p> <p>LXK0255604</p> <p>Name : Laltanpui Father's Name : Vanhnuailiana House Number (Notional) : 12 Age : 29 Gender : Female</p> <p>Photo Available</p>
<p>46</p> <p>JKF0188870</p> <p>Name : Zoremsiama Father's Name : Lalrinthanga House Number (Notional) : 13 Age : 36 Gender : Male</p> <p>Photo Available</p>	<p>47</p> <p>LXK0213090</p> <p>Name : R. Vanlalruati Father's Name : Vanhnuailiana House Number (Notional) : 13 Age : 33 Gender : Female</p> <p>Photo Available</p>	<p>48</p> <p>LXK0173898</p> <p>Name : T. Rodinthanga Father's Name : Thangnawna (L) House Number (Notional) : 14 Age : 57 Gender : Male</p> <p>Photo Available</p>
<p>49</p> <p>LXK0056812</p> <p>Name : Vanlalpeka Father's Name : Lalibata House Number (Notional) : 15 Age : 43 Gender : Male</p> <p>Photo Available</p>	<p>50</p> <p>LXK0213280</p> <p>Name : Chawngpui Husband's Name : Vanlalpeka House Number (Notional) : 15 Age : 33 Gender : Female</p> <p>Photo Available</p>	<p>51</p> <p>RHE0112672</p> <p>Name : Lalmuangpui Father's Name : Vanlalpeka House Number (Notional) : 15 Age : 19 Gender : Female</p> <p>Photo Available</p>
<p>52</p> <p>LXK0056309</p> <p>Name : H. Lalchhuanmawii Husband's Name : C. Lalbiakkunga House Number (Notional) : 16 Age : 40 Gender : Female</p> <p>Photo Available</p>	<p>53</p> <p>LXK0095331</p> <p>Name : Ngurchhawna Father's Name : Lalthanauva House Number (Notional) : 17 Age : 73 Gender : Male</p> <p>Photo Available</p>	<p>54</p> <p>LXK0095349</p> <p>Name : Lalramhluni Varte Father's Name : Ngurchhawna House Number (Notional) : 17 Age : 53 Gender : Female</p> <p>Photo Available</p>
<p>55</p> <p>LHM0197095</p> <p>Name : Vanlalhruala Father's Name : Ngurchhawna House Number (Notional) : 17 Age : 51 Gender : Male</p> <p>Photo Available</p>	<p>56</p> <p>LXK0056283</p> <p>Name : Lalhmumawii Father's Name : Ngurchhawna House Number (Notional) : 17 Age : 40 Gender : Female</p> <p>Photo Available</p>	<p>57</p> <p>LXK0213157</p> <p>Name : H. Lalduhzuali Father's Name : Ngurchhawna House Number (Notional) : 17 Age : 34 Gender : Female</p> <p>Photo Available</p>
<p>58</p> <p>RHE0020362</p> <p>Name : C. Zonunmawia Mother's Name : Lalramhluni House Number (Notional) : 17 Age : 32 Gender : Male</p> <p>Photo Available</p>	<p>59</p> <p>LXK0057612</p> <p>Name : Rinthangi Husband's Name : Vanlalrina House Number (Notional) : 18 Age : 65 Gender : Female</p> <p>Photo Available</p>	<p>60</p> <p>LXK0055251</p> <p>Name : Lalbiakvela Father's Name : Vanlalrina House Number (Notional) : 18 Age : 42 Gender : Male</p> <p>Photo Available</p>

<p>61</p> <p>TXU0011759</p> <p>Name : Ngurdingliani Husband's Name: Lalramhluna House Number (Notional) : 18 Age : 36 Gender : Female</p> <p>Photo Available</p>	<p>62</p> <p>LXK0059857</p> <p>Name : Lalrinchhana Father's Name: Vanlalrina House Number (Notional) : 18 Age : 33 Gender : Male</p> <p>Photo Available</p>	<p>63</p> <p>LXK0057125</p> <p>Name : Lalfakzuali Husband's Name: K. Lalremmawia House Number (Notional) : 19 Age : 47 Gender : Female</p> <p>Photo Available</p>
<p>64</p> <p>LXK0057133</p> <p>Name : K. Lalremmawia Father's Name: Vanlalrina House Number (Notional) : 19 Age : 46 Gender : Male</p> <p>Photo Available</p>	<p>65</p> <p>LXK0056101</p> <p>Name : R. Lalchhanhima Father's Name: R. Lalsangliana House Number (Notional) : 20 Age : 55 Gender : Male</p> <p>Photo Available</p>	<p>66</p> <p>CBM0037671</p> <p>Name : T. C. Lalengmawii Husband's Name: R. Lalchhanhima House Number (Notional) : 20 Age : 48 Gender : Female</p> <p>Photo Available</p>
<p>67</p> <p>LXK0055095</p> <p>Name : Lalhansiamia Father's Name: Lalfakzuala House Number (Notional) : 21 Age : 44 Gender : Male</p> <p>Photo Available</p>	<p>68</p> <p>LXK0260372</p> <p>Name : Lalramliani Husband's Name: Lalhansiamia House Number (Notional) : 21 Age : 44 Gender : Female</p> <p>Photo Available</p>	<p>69</p> <p>LXK0056291</p> <p>Name : R. Lalhafamkimi Father's Name: Lalfakzuala House Number (Notional) : 21 Age : 41 Gender : Female</p> <p>Photo Available</p>
<p>70</p> <p>LXK0057067</p> <p>Name : R. Lalhruaitluanga Father's Name: Lalfakzuala House Number (Notional) : 21 Age : 40 Gender : Male</p> <p>Photo Available</p>	<p>71</p> <p>LXK0056796</p> <p>Name : C. Lalnunsiami Husband's Name: R. Lalhruaitluanga House Number (Notional) : 21 Age : 40 Gender : Female</p> <p>Photo Available</p>	<p>72</p> <p>TEQ0028902</p> <p>Name : Marina Lalhlimpuii Father's Name: Lalchawimawia House Number (Notional) : 22 Age : 31 Gender : Female</p> <p>Photo Available</p>
<p>73</p> <p>TEQ0029066</p> <p>Name : Paul H. D. Lalruatkima Father's Name: Imanuel Lalremruata House Number (Notional) : 22 Age : 29 Gender : Male</p> <p>Photo Available</p>	<p>74</p> <p>RHE0020552</p> <p>Name : Lalnunpuii Father's Name: Rama House Number (Notional) : 23 Age : 32 Gender : Female</p> <p>Photo Available</p>	<p>75</p> <p>RHE0011742</p> <p>Name : Vanlalringa Mother's Name: Nemvungi House Number (Notional) : 23 Age : 30 Gender : Male</p> <p>Photo Available</p>
<p>76</p> <p>RHE0020560</p> <p>Name : Lalpianga Father's Name: Laikhuma House Number (Notional) : 24 Age : 36 Gender : Male</p> <p>Photo Available</p>	<p>77</p> <p>LXK0212951</p> <p>Name : Lalduhawmi Father's Name: Rualkunga House Number (Notional) : 24 Age : 33 Gender : Female</p> <p>Photo Available</p>	<p>78</p> <p>LXK0057513</p> <p>Name : Rallianthanga Father's Name: Chengtawnga (L) House Number (Notional) : 25 Age : 77 Gender : Male</p> <p>Photo Available</p>
<p>79</p> <p>LXK0057521</p> <p>Name : K. Lalthakimi Husband's Name: Rallianthanga House Number (Notional) : 25 Age : 73 Gender : Female</p> <p>Photo Available</p>	<p>80</p> <p>LXK0055954</p> <p>Name : R. K. Lalrindika Father's Name: Rallianthanga House Number (Notional) : 25 Age : 44 Gender : Male</p> <p>Photo Available</p>	<p>81</p> <p>LXK0059873</p> <p>Name : Lalhawhpuii Father's Name: Rallianthanga House Number (Notional) : 25 Age : 34 Gender : Female</p> <p>Photo Available</p>
<p>82</p> <p>ICH0038869</p> <p>Name : Lalthianghlimi Father's Name: Saiziki Sailo House Number (Notional) : 25 Age : 27 Gender : Female</p> <p>Photo Available</p>	<p>83</p> <p>LXK0212977</p> <p>Name : Vanlalengi Husband's Name: Dr. Lalchungnunga Pudaite House Number (Notional) : 26 Age : 57 Gender : Female</p> <p>Photo Available</p>	<p>84</p> <p>LXK0059766</p> <p>Name : Rachael Lalsangzuol Pudaite Father's Name: Dr. Lalchungnunga Pudaite House Number (Notional) : 26 Age : 39 Gender : Female</p> <p>Photo Available</p>
<p>85</p> <p>RHE0007328</p> <p>Name : Chistina Vanrammawii Pudaite Father's Name: DR. Lalchungnunga Pudaite House Number (Notional) : 26 Age : 37 Gender : Female</p> <p>Photo Available</p>	<p>86</p> <p>LXK0255695</p> <p>Name : Arnold Lalringa Pudaite Father's Name: Dr. Lalchungnunga Pudaite House Number (Notional) : 26 Age : 35 Gender : Male</p> <p>Photo Available</p>	<p>87</p> <p>RHE0011676</p> <p>Name : Josephine Lalrinmawii Pudaite Father's Name: Dr. Lalchungnunga Pudaite House Number (Notional) : 26 Age : 33 Gender : Female</p> <p>Photo Available</p>
<p>88</p> <p>RHE0104687</p> <p>Name : Poonam Lalithlawnepek Father's Name: Lainghaklien Buhri House Number (Notional) : 26 Age : 32 Gender : Female</p> <p>Photo Available</p>	<p>89</p> <p>ZXI0058354</p> <p>Name : Vanlalhlimpuii Father's Name: Vanlalawma (L) House Number (Notional) : 26 Age : 26 Gender : Female</p> <p>Photo Available</p>	<p>90</p> <p>LXK0056200</p> <p>Name : Thankungi Husband's Name: Robuanga House Number (Notional) : 27 Age : 62 Gender : Female</p> <p>Photo Available</p>

<p>91</p> <p>LXK0055947</p> <p>Name : Lalmangaihzuala Father's Name: Robuanga House Number (Notional) : 27 Age : 36 Gender : Male</p> <p>Photo</p> <p>Available</p>	<p>92</p> <p>RHE0086314</p> <p>Name : Lalruatfeli Father's Name: Lalremruata House Number (Notional) : 27 Age : 22 Gender : Female</p> <p>Photo</p> <p>Available</p>	<p>93</p> <p>LXK0055434</p> <p>Name : C. Laldinggheta Father's Name: Selhnuna House Number (Notional) : 28 Age : 68 Gender : Male</p> <p>Photo</p> <p>Available</p>
<p>94</p> <p>LXK0055558</p> <p>Name : Chuauhmingliani Husband's Name: C. Laldinggheta House Number (Notional) : 28 Age : 66 Gender : Female</p> <p>Photo</p> <p>Available</p>	<p>95</p> <p>LXK0042226</p> <p>Name : C. Lainunkima Father's Name: C. Laldinggheta House Number (Notional) : 28 Age : 42 Gender : Male</p> <p>Photo</p> <p>Available</p>	<p>96</p> <p>LXK0059949</p> <p>Name : C. Lainunthara Father's Name: C. Laldinggheta House Number (Notional) : 28 Age : 39 Gender : Male</p> <p>Photo</p> <p>Available</p>
<p>97</p> <p>LXK0212837</p> <p>Name : C. Lalawmpuia Father's Name: C. Laldinggheta House Number (Notional) : 28 Age : 38 Gender : Male</p> <p>Photo</p> <p>Available</p>	<p>98</p> <p>APS0050252</p> <p>Name : Lalromawii Father's Name: Lalbattiana House Number (Notional) : 28 Age : 28 Gender : Female</p> <p>Photo</p> <p>Available</p>	<p>99</p> <p>RHE0049197</p> <p>Name : Lalmuanpuii Father's Name: Zingengmawia House Number (Notional) : 28 Age : 28 Gender : Female</p> <p>Photo</p> <p>Available</p>
<p>100</p> <p>JTB0199067</p> <p>Name : Thanghausiama Father's Name: Kaipauva House Number (Notional) : 29 Age : 36 Gender : Male</p> <p>Photo</p> <p>Available</p>	<p>101</p> <p>JTB0198143</p> <p>Name : Vungzakhama Father's Name: Kaipauva House Number (Notional) : 29 Age : 33 Gender : Male</p> <p>Photo</p> <p>Available</p>	<p>102</p> <p>NSM1258425</p> <p>Name : Biakmawii Father's Name: Thangzamanga House Number (Notional) : 29 Age : 31 Gender : Female</p> <p>Photo</p> <p>Available</p>
<p>103</p> <p>NJP0059634</p> <p>Name : Mary Remruatmawii Father's Name: Kaipauva House Number (Notional) : 29 Age : 28 Gender : Female</p> <p>Photo</p> <p>Available</p>	<p>104</p> <p>LXK0235606</p> <p>Name : Thangkhenmang Father's Name: Thiangothang House Number (Notional) : 30 Age : 51 Gender : Male</p> <p>Photo</p> <p>Available</p>	<p>105</p> <p>RHE0063446</p> <p>Name : Ngaihniang Husband's Name: Thangkhenmang House Number (Notional) : 30 Age : 49 Gender : Female</p> <p>Photo</p> <p>Available</p>
<p>106</p> <p>RHE0063545</p> <p>Name : Theilunkimi Father's Name: Thangkhenmang House Number (Notional) : 30 Age : 26 Gender : Female</p> <p>Photo</p> <p>Available</p>	<p>107</p> <p>RHE0082487</p> <p>Name : G. Liana Father's Name: T. K. Manga House Number (Notional) : 30 Age : 23 Gender : Male</p> <p>Photo</p> <p>Available</p>	<p>108</p> <p>FDV0199489</p> <p>Name : Nemvungi Father's Name: Ngurhnema House Number (Notional) : 31 Age : 49 Gender : Female</p> <p>Photo</p> <p>Available</p>
<p>109</p> <p>RHE0048603</p> <p>Name : Malsawmdawngliana Mother's Name: Nemvungi House Number (Notional) : 31 Age : 30 Gender : Male</p> <p>Photo</p> <p>Available</p>	<p>110</p> <p>RHE0052951</p> <p>Name : Vanlaifela Mother's Name: Nemvungi House Number (Notional) : 31 Age : 27 Gender : Male</p> <p>Photo</p> <p>Available</p>	<p>111</p> <p>RHE0070862</p> <p>Name : Lalruatfela Mother's Name: Nemvungi House Number (Notional) : 31 Age : 24 Gender : Male</p> <p>Photo</p> <p>Available</p>
<p>112</p> <p>MYV0161687</p> <p>Name : Ngurnunmawia Father's Name: Saizika Sailo House Number (Notional) : 32 Age : 36 Gender : Male</p> <p>Photo</p> <p>Available</p>	<p>113</p> <p>MKS0238808</p> <p>Name : C. Lalremsangi Husband's Name: Ngurnunmawia House Number (Notional) : 32 Age : 35 Gender : Female</p> <p>Photo</p> <p>Available</p>	<p>114</p> <p>LXK0235556</p> <p>Name : Chhuankima Father's Name: Pakhleia House Number (Notional) : 33 Age : 45 Gender : Male</p> <p>Photo</p> <p>Available</p>
<p>115</p> <p>LXK0235549</p> <p>Name : Lalthangliani Husband's Name: Lalchhuankima House Number (Notional) : 33 Age : 34 Gender : Female</p> <p>Photo</p> <p>Available</p>	<p>116</p> <p>CQL0582429</p> <p>Name : F. Lalchhanhima Father's Name: F. Kapthanga House Number (Notional) : 34 Age : 43 Gender : Male</p> <p>Photo</p> <p>Available</p>	<p>117</p> <p>JTB0058339</p> <p>Name : Lalramchhani Husband's Name: F. Lalchhanhima House Number (Notional) : 34 Age : 43 Gender : Female</p> <p>Photo</p> <p>Available</p>
<p>118</p> <p>LXK0213314</p> <p>Name : C. Lalthianghlima Father's Name: Saidailova House Number (Notional) : 35 Age : 66 Gender : Male</p> <p>Photo</p> <p>Available</p>	<p>119</p> <p>LXK0057000</p> <p>Name : C. Tlangthanmawia Father's Name: C. Lalthianghlima House Number (Notional) : 35 Age : 44 Gender : Male</p> <p>Photo</p> <p>Available</p>	<p>120</p> <p>MPS0135962</p> <p>Name : Vanlalhluni Sailo Husband's Name: C. Tlangthanmawia House Number (Notional) : 35 Age : 41 Gender : Female</p> <p>Photo</p> <p>Available</p>

<p>121</p> <p>RHE0086330</p> <p>Name : C.Lalnumawia Father's Name : C.Tiangthanmawia House Number (Notional) : 35 Age : 22 Gender : Male</p> <p>Photo Available</p>	<p>122</p> <p>LXK0213058</p> <p>Name : Lalhmingchhuangi Father's Name : Lalthansanga House Number (Notional) : 36 Age : 37 Gender : Female</p> <p>Photo Available</p>	<p>123</p> <p>LXK0235614</p> <p>Name : Zosangzuala Father's Name : Lainunmawia House Number (Notional) : 36 Age : 35 Gender : Male</p> <p>Photo Available</p>
<p>124</p> <p>LXK0056572</p> <p>Name : Lalzuilliani Husband's Name : C. Zakapa House Number (Notional) : 37 Age : 61 Gender : Female</p> <p>Photo Available</p>	<p>125</p> <p>LXK0223040</p> <p>Name : Caroline Lalremsiami Father's Name : C. Zakapa House Number (Notional) : 37 Age : 34 Gender : Female</p> <p>Photo Available</p>	<p>126</p> <p>LXK0235630</p> <p>Name : Lalthanmawia Father's Name : Lalmalsawma House Number (Notional) : 38 Age : 52 Gender : Male</p> <p>Photo Available</p>
<p>127</p> <p>RHE0063453</p> <p>Name : Lalawmpuii Husband's Name : Lalthanmawia House Number (Notional) : 38 Age : 49 Gender : Female</p> <p>Photo Available</p>	<p>128</p> <p>RHE0070854</p> <p>Name : Lalhruaitluanga Tuallawt Father's Name : Lalthanmawia House Number (Notional) : 38 Age : 24 Gender : Male</p> <p>Photo Available</p>	<p>129</p> <p>LXK0095414</p> <p>Name : Khawchingi Husband's Name : Laibata House Number (Notional) : 39 Age : 74 Gender : Female</p> <p>Photo Available</p>
<p>130</p> <p>RIA0011619</p> <p>Name : Lalhimpuii Father's Name : Haria (L) House Number (Notional) : 39 Age : 34 Gender : Female</p> <p>Photo Available</p>	<p>131</p> <p>LXK0260364</p> <p>Name : K. C. Thanga Father's Name : Laibata House Number (Notional) : 39 Age : 33 Gender : Male</p> <p>Photo Available</p>	<p>132</p> <p>RHE0020412</p> <p>Name : Kapnunsanga Father's Name : Laibata (L) House Number (Notional) : 39 Age : 32 Gender : Male</p> <p>Photo Available</p>
<p>133</p> <p>RHE0029926</p> <p>Name : Lalrindiki Husband's Name : Thangmungmuanga House Number (Notional) : 39 Age : 30 Gender : Female</p> <p>Photo Available</p>	<p>134</p> <p>LXK0042465</p> <p>Name : K. Lalchhanhimi Father's Name : K. Thankunga (L) House Number (Notional) : 40 Age : 51 Gender : Female</p> <p>Photo Available</p>	<p>135</p> <p>LXK0055988</p> <p>Name : K. Lalremruata Father's Name : K. Thankunga (L) House Number (Notional) : 40 Age : 48 Gender : Male</p> <p>Photo Available</p>
<p>136</p> <p>NJP0020552</p> <p>Name : Vanlalsiami Husband's Name : K. Lalremruata House Number (Notional) : 40 Age : 32 Gender : Female</p> <p>Photo Available</p>	<p>137</p> <p>LXK0095422</p> <p>Name : Lalnunziri Husband's Name : Lalnunmawia House Number (Notional) : 41 Age : 57 Gender : Female</p> <p>Photo Available</p>	<p>138</p> <p>LXK0056416</p> <p>Name : Lalnunmawia Father's Name : Patea (L) House Number (Notional) : 41 Age : 54 Gender : Male</p> <p>Photo Available</p>
<p>139</p> <p>LXK0213074</p> <p>Name : Lalremchhungi Father's Name : Lalnunmawia House Number (Notional) : 41 Age : 33 Gender : Female</p> <p>Photo Available</p>	<p>140</p> <p>RHE0048538</p> <p>Name : Lalhriatkima Father's Name : Lalnunmawia House Number (Notional) : 41 Age : 28 Gender : Male</p> <p>Photo Available</p>	<p>141</p> <p>RHE0053033</p> <p>Name : Lalduhi Husband's Name : Uttam Kumar House Number (Notional) : 42 Age : 43 Gender : Female</p> <p>Photo Available</p>
<p>142</p> <p>RHE0053025</p> <p>Name : Uttam Kumar Father's Name : Indra Bhadur House Number (Notional) : 42 Age : 40 Gender : Male</p> <p>Photo Available</p>	<p>143</p> <p>RHE0082495</p> <p>Name : Lalnunpuii Father's Name : Uttam Kumar House Number (Notional) : 42 Age : 23 Gender : Female</p> <p>Photo Available</p>	<p>144</p> <p>RHE0052969</p> <p>Name : Ram Bahadur Father's Name : Mon Bahadur Rana House Number (Notional) : 43 Age : 44 Gender : Male</p> <p>Photo Available</p>
<p>145</p> <p>RHE0103846</p> <p>Name : Chandra Rana Father's Name : Ram Bahadur Rana House Number (Notional) : 43 Age : 20 Gender : Male</p> <p>Photo Available</p>	<p>146</p> <p>LXF0100578</p> <p>Name : Lalnunsemi Husband's Name : Lalremsiama House Number (Notional) : 44 Age : 39 Gender : Female</p> <p>Photo Available</p>	<p>147</p> <p>RHE0020545</p> <p>Name : Lalremsiama Father's Name : Rama House Number (Notional) : 44 Age : 33 Gender : Male</p> <p>Photo Available</p>
<p>148</p> <p>RHE0048611</p> <p>Name : Laldika Father's Name : Rana House Number (Notional) : 44 Age : 29 Gender : Male</p> <p>Photo Available</p>	<p>149</p> <p>RHE0020537</p> <p>Name : Lalbiakzuala Father's Name : Chhunthanga (L) House Number (Notional) : 45 Age : 48 Gender : Male</p> <p>Photo Available</p>	<p>150</p> <p>LXK0059808</p> <p>Name : Biakchhingi Husband's Name : Lalbiakzuala House Number (Notional) : 45 Age : 42 Gender : Female</p> <p>Photo Available</p>

<p>151</p> <p>RHE0108282</p> <p>Name : R. Lalnunkimi Father's Name: Lalbiakzuala House Number (Notional) : 45 Age : 19 Gender : Female</p> <p>Photo Available</p>	<p>152</p> <p>LXK0056820</p> <p>Name : Ngurbiakthanga Father's Name: Thangbuanga (L) House Number (Notional) : 46 Age : 69 Gender : Male</p> <p>Photo Available</p>	<p>153</p> <p>LXK0057430</p> <p>Name : Lalhmingliani Husband's Name: Ngurbiakthanga House Number (Notional) : 46 Age : 62 Gender : Female</p> <p>Photo Available</p>
<p>154</p> <p>LXK0212753</p> <p>Name : P. C. Zoramthara Father's Name: Ngurbiakthanga House Number (Notional) : 46 Age : 37 Gender : Male</p> <p>Photo Available</p>	<p>155</p> <p>LXK0235523</p> <p>Name : P.C. Lalhriatkimi Father's Name: Ngurbiakthanga House Number (Notional) : 46 Age : 35 Gender : Female</p> <p>Photo Available</p>	<p>156</p> <p>LXK0057471</p> <p>Name : Lalhmingthari Husband's Name: T. Thangzuala House Number (Notional) : 47 Age : 66 Gender : Female</p> <p>Photo Available</p>
<p>157</p> <p>LXK0056192</p> <p>Name : T. Thangzuala Father's Name: K. T. Chhana House Number (Notional) : 47 Age : 61 Gender : Male</p> <p>Photo Available</p>	<p>158</p> <p>LXK0213140</p> <p>Name : Lalrindika Father's Name: T. Thangzuala House Number (Notional) : 47 Age : 37 Gender : Male</p> <p>Photo Available</p>	<p>159</p> <p>RHE0011718</p> <p>Name : Lalrintluanga Father's Name: T. Thangzuala House Number (Notional) : 47 Age : 33 Gender : Male</p> <p>Photo Available</p>
<p>160</p> <p>RHE0020297</p> <p>Name : Ngurthansiami Sailo Husband's Name: Lalrintluanga House Number (Notional) : 47 Age : 32 Gender : Female</p> <p>Photo Available</p>	<p>161</p> <p>RHE0024224</p> <p>Name : Lalnunhlimi Father's Name: T. Thangzuala House Number (Notional) : 47 Age : 31 Gender : Female</p> <p>Photo Available</p>	<p>162</p> <p>RHE0037507</p> <p>Name : Lalremuati Husband's Name: Lalrindika House Number (Notional) : 47 Age : 31 Gender : Female</p> <p>Photo Available</p>
<p>163</p> <p>MQG0125104</p> <p>Name : Linda Lalhruaitluangi Husband's Name: Lalchhuanawma House Number (Notional) : 48 Age : 38 Gender : Female</p> <p>Photo Available</p>	<p>164</p> <p>LXK0213066</p> <p>Name : Lalchhuanawma Father's Name: Lalnunmawia House Number (Notional) : 48 Age : 36 Gender : Male</p> <p>Photo Available</p>	<p>165</p> <p>RHE0011767</p> <p>Name : Lalremsiami Husband's Name: H. Lalsawta House Number (Notional) : 49 Age : 56 Gender : Female</p> <p>Photo Available</p>
<p>166</p> <p>RHE0029934</p> <p>Name : David Lalkhawngaiha Father's Name: Lalsawta (L) House Number (Notional) : 49 Age : 30 Gender : Male</p> <p>Photo Available</p>	<p>167</p> <p>RHE0063560</p> <p>Name : Ruthi Lalnunziri Father's Name: Lalsawta House Number (Notional) : 49 Age : 25 Gender : Female</p> <p>Photo Available</p>	<p>168</p> <p>LXK0212779</p> <p>Name : Hmangaihzuala Father's Name: Tawna (L) House Number (Notional) : 50 Age : 69 Gender : Male</p> <p>Photo Available</p>
<p>169</p> <p>LXK0212845</p> <p>Name : R. Vanlairuati Father's Name: Hmangaihzuala House Number (Notional) : 50 Age : 36 Gender : Female</p> <p>Photo Available</p>	<p>170</p> <p>LXK0255711</p> <p>Name : R. Lalremtuangi Father's Name: Hmangaihzuala House Number (Notional) : 50 Age : 34 Gender : Female</p> <p>Photo Available</p>	<p>171</p> <p>RHE0020438</p> <p>Name : R. Lalnuanpuui Father's Name: Hmangaihzuala House Number (Notional) : 50 Age : 32 Gender : Female</p> <p>Photo Available</p>
<p>172</p> <p>JSX0049049</p> <p>Name : Thankima Father's Name: Biakliana House Number (Notional) : 51 Age : 67 Gender : Male</p> <p>Photo Available</p>	<p>173</p> <p>LXK0055731</p> <p>Name : Lalremsanga Father's Name: Rallianthanga House Number (Notional) : 51 Age : 50 Gender : Male</p> <p>Photo Available</p>	<p>174</p> <p>LXK0056341</p> <p>Name : Lalthafamkimi Husband's Name: Lalremsanga House Number (Notional) : 51 Age : 46 Gender : Female</p> <p>Photo Available</p>
<p>175</p> <p>RHE0058750</p> <p>Name : Fredy Vanlalnunmawia Father's Name: Lalremsanga House Number (Notional) : 51 Age : 26 Gender : Male</p> <p>Photo Available</p>	<p>176</p> <p>RHE0082461</p> <p>Name : Lalntuangezela Father's Name: Lalremsanga House Number (Notional) : 51 Age : 23 Gender : Male</p> <p>Photo Available</p>	<p>177</p> <p>RHE0102095</p> <p>Name : Lalruatpuia Father's Name: Lalremsanga House Number (Notional) : 51 Age : 20 Gender : Male</p> <p>Photo Available</p>
<p>178</p> <p>MKS0038976</p> <p>Name : K. Zaithanmawia Father's Name: Hrangthankima House Number (Notional) : 52 Age : 54 Gender : Male</p> <p>Photo Available</p>	<p>179</p> <p>MKS0039008</p> <p>Name : Chawngthanzuali Husband's Name: K. Zaithanmawia House Number (Notional) : 52 Age : 51 Gender : Female</p> <p>Photo Available</p>	<p>180</p> <p>RHE0048561</p> <p>Name : K. Lalbiakfela Father's Name: K. Zaithanmawia House Number (Notional) : 52 Age : 28 Gender : Male</p> <p>Photo Available</p>

<p>181</p> <p>RHE0063529</p> <p>Name : K. Lalfakmawii Father's Name : K. Zaihanmawia House Number (Notional) : 52 Age : 25 Gender : Female</p> <p>Photo Available</p>	<p>182</p> <p>RHE0086322</p> <p>Name : K.Lalfakkimi Father's Name : K.Zaihanmawia House Number (Notional) : 52 Age : 22 Gender : Female</p> <p>Photo Available</p>	<p>183</p> <p>LXK0158907</p> <p>Name : Englawmi Husband's Name : P. Ramnunsanga House Number (Notional) : 53 Age : 46 Gender : Female</p> <p>Photo Available</p>
<p>184</p> <p>CDN0105221</p> <p>Name : P. Ramnunsanga Father's Name : P. Ronghaka House Number (Notional) : 53 Age : 46 Gender : Male</p> <p>Photo Available</p>	<p>185</p> <p>LXK0235572</p> <p>Name : Lalengmawia Father's Name : Chalhmingliana House Number (Notional) : 54 Age : 41 Gender : Male</p> <p>Photo Available</p>	<p>186</p> <p>RHE0007336</p> <p>Name : Saihmingthangi Husband's Name : Lalengmawia House Number (Notional) : 54 Age : 38 Gender : Female</p> <p>Photo Available</p>
<p>187</p> <p>LXF0063412</p> <p>Name : Laingaihawma Father's Name : Lalthanga House Number (Notional) : 55 Age : 45 Gender : Male</p> <p>Photo Available</p>	<p>188</p> <p>LXF0066969</p> <p>Name : Laichhanhimi Husband's Name : Laingaihawma House Number (Notional) : 55 Age : 42 Gender : Female</p> <p>Photo Available</p>	<p>189</p> <p>RHE0108266</p> <p>Name : Vanlahriatenga Father's Name : Laingaihawma House Number (Notional) : 55 Age : 19 Gender : Male</p> <p>Photo Available</p>
<p>190</p> <p>LXK0256198</p> <p>Name : Lalrosiama Father's Name : Zodinthara House Number (Notional) : 56 Age : 38 Gender : Male</p> <p>Photo Available</p>	<p>191</p> <p>LXK0256172</p> <p>Name : Hmingthantluangi Husband's Name : Lalrosiama House Number (Notional) : 56 Age : 36 Gender : Female</p> <p>Photo Available</p>	<p>192</p> <p>RHE0052977</p> <p>Name : Sonika Soren Father's Name : Hopna Soren House Number (Notional) : 56 Age : 28 Gender : Female</p> <p>Photo Available</p>
<p>193</p> <p>RHE0102046</p> <p>Name : Binita Soren Father's Name : Hopna Soren House Number (Notional) : 56 Age : 20 Gender : Female</p> <p>Photo Available</p>	<p>194</p> <p>GDP0125518</p> <p>Name : Hunlawmawma Father's Name : Lalvuana House Number (Notional) : 57 Age : 41 Gender : Male</p> <p>Photo Available</p>	<p>195</p> <p>LXK0059790</p> <p>Name : Lalzikipui Father's Name : Dokunga House Number (Notional) : 57 Age : 33 Gender : Female</p> <p>Photo Available</p>
<p>196</p> <p>RHE0108274</p> <p>Name : Lallawmsanga Father's Name : Hunlawmawma House Number (Notional) : 57 Age : 19 Gender : Male</p> <p>Photo Available</p>	<p>197</p> <p>LXK0055756</p> <p>Name : Lalruatfeli Royte Husband's Name : C. Lalrinmawia House Number (Notional) : 58 Age : 41 Gender : Female</p> <p>Photo Available</p>	<p>198</p> <p>RHE0058677</p> <p>Name : Malsawmtluangi Father's Name : Lalrinmawia House Number (Notional) : 58 Age : 26 Gender : Female</p> <p>Photo Available</p>
<p>199</p> <p>LXK0023093</p> <p>Name : Zaihanhimi Husband's Name : J. Vanlahghaka House Number (Notional) : 59 Age : 58 Gender : Female</p> <p>Photo Available</p>	<p>200</p> <p>RHE0001669</p> <p>Name : Lalhmingsangi Father's Name : J. Vanlahghaka House Number (Notional) : 59 Age : 37 Gender : Female</p> <p>Photo Available</p>	<p>201</p> <p>LXK0235317</p> <p>Name : Lalfakawmi Father's Name : J. Vanlahghaka House Number (Notional) : 59 Age : 36 Gender : Female</p> <p>Photo Available</p>
<p>202</p> <p>RHE0013946</p> <p>Name : Remlalmuana Father's Name : Vanlahghaka House Number (Notional) : 59 Age : 34 Gender : Male</p> <p>Photo Available</p>	<p>203</p> <p>RHE0029942</p> <p>Name : Lalhriatenga Father's Name : Vanlahghaka House Number (Notional) : 59 Age : 32 Gender : Male</p> <p>Photo Available</p>	<p>204</p> <p>LXK0056648</p> <p>Name : Lalsiamliana Father's Name : Vanlahmuaka House Number (Notional) : 60 Age : 36 Gender : Male</p> <p>Photo Available</p>
<p>205</p> <p>RHE0020396</p> <p>Name : Lalvanpui Husband's Name : Lalsiamliana House Number (Notional) : 60 Age : 33 Gender : Female</p> <p>Photo Available</p>	<p>206</p> <p>CDN0148908</p> <p>Name : Dr. H. Prasad Father's Name : P.N Ram House Number (Notional) : 61 Age : 60 Gender : Male</p> <p>Photo Available</p>	<p>207</p> <p>CDN0087320</p> <p>Name : Geeta Prasad Husband's Name : Dr. H. Prasad House Number (Notional) : 61 Age : 58 Gender : Female</p> <p>Photo Available</p>
<p>208</p> <p>TXB0015305</p> <p>Name : Abhishek Prasad Father's Name : Dr. H. Prasad House Number (Notional) : 61 Age : 32 Gender : Male</p> <p>Photo Available</p>	<p>209</p> <p>RHE0037556</p> <p>Name : Alisha Prasad Father's Name : Dr. Hridayesh Prasad House Number (Notional) : 61 Age : 31 Gender : Female</p> <p>Photo Available</p>	<p>210</p> <p>LXK0235507</p> <p>Name : Onzamanga Father's Name : Thangkawsela House Number (Notional) : 62 Age : 48 Gender : Male</p> <p>Photo Available</p>

<p>211</p> <p>RHE0063438</p> <p>Name : Holkhopao Lhungdim Father's Name : Jangthonga House Number (Notional) : 63 Age : 49 Gender : Male</p> <p>Photo Available</p>	<p>212</p> <p>LXK0235457</p> <p>Name : Hoinui Husband's Name : Holkhopauva House Number (Notional) : 63 Age : 37 Gender : Female</p> <p>Photo Available</p>	<p>213</p> <p>BPD0058172</p> <p>Name : R. Chhingpui Husband's Name : F. Lalringgheta House Number (Notional) : 64 Age : 55 Gender : Female</p> <p>Photo Available</p>
<p>214</p> <p>RHE0052928</p> <p>Name : F. Lalremruatkima Father's Name : F. Lalringgheta House Number (Notional) : 64 Age : 27 Gender : Male</p> <p>Photo Available</p>	<p>215</p> <p>RHE0075317</p> <p>Name : Reuben Lainunzira Father's Name : F. Lalringgheta House Number (Notional) : 64 Age : 24 Gender : Male</p> <p>Photo Available</p>	<p>216</p> <p>RHE0093542</p> <p>Name : Dorothy F. Lalawmpui Father's Name : F. Lalringgheta (L) House Number (Notional) : 64 Age : 21 Gender : Female</p> <p>Photo Available</p>
<p>217</p> <p>DJQ0248682</p> <p>Name : Lungkhohao Gangte Father's Name : Zamlung House Number (Notional) : 65 Age : 61 Gender : Male</p> <p>Photo Available</p>	<p>218</p> <p>DJQ0012948</p> <p>Name : Ngakneichin Gangte Husband's Name : Lungkhohao House Number (Notional) : 65 Age : 59 Gender : Female</p> <p>Photo Available</p>	<p>219</p> <p>RHE0048629</p> <p>Name : Thehminlai Father's Name : Lungkhohao Gangte House Number (Notional) : 65 Age : 28 Gender : Male</p> <p>Photo Available</p>
<p>220</p> <p>RHE0063586</p> <p>Name : Ngahhoikim Father's Name : Lungkhohao Gangte House Number (Notional) : 65 Age : 26 Gender : Female</p> <p>Photo Available</p>	<p>221</p> <p>LXK0057356</p> <p>Name : Zohliri Husband's Name : T. Zakhama House Number (Notional) : 66 Age : 60 Gender : Female</p> <p>Photo Available</p>	<p>222</p> <p>LXK0056267</p> <p>Name : T. Zakhama Father's Name : T. Nenga (L) House Number (Notional) : 66 Age : 59 Gender : Male</p> <p>Photo Available</p>
<p>223</p> <p>LXK0055293</p> <p>Name : Muanthanga Tonsing Father's Name : T. Zakhama House Number (Notional) : 66 Age : 40 Gender : Male</p> <p>Photo Available</p>	<p>224</p> <p>LXK0059816</p> <p>Name : T. Lalrinmawia Father's Name : T. Zakhama House Number (Notional) : 66 Age : 36 Gender : Male</p> <p>Photo Available</p>	<p>225</p> <p>LXK0255802</p> <p>Name : Zakimi Father's Name : T. Zakhama House Number (Notional) : 66 Age : 29 Gender : Female</p> <p>Photo Available</p>
<p>226</p> <p>RHE0048546</p> <p>Name : T. Lalrinpuia Father's Name : T. Zakhama House Number (Notional) : 66 Age : 28 Gender : Male</p> <p>Photo Available</p>	<p>227</p> <p>TEQ0011320</p> <p>Name : Lalrinchuanga Father's Name : Zakapruma House Number (Notional) : 67 Age : 35 Gender : Male</p> <p>Photo Available</p>	<p>228</p> <p>ZXI0015339</p> <p>Name : Lalbiaknii Husband's Name : Lalrinchuanga House Number (Notional) : 67 Age : 32 Gender : Female</p> <p>Photo Available</p>
<p>229</p> <p>TEQ0041822</p> <p>Name : Laitanpui Father's Name : Zaituathanga House Number (Notional) : 68 Age : 30 Gender : Female</p> <p>Photo Available</p>	<p>230</p> <p>TEQ0041723</p> <p>Name : Bonny Lalrindika Father's Name : Lalnunmawia House Number (Notional) : 68 Age : 28 Gender : Male</p> <p>Photo Available</p>	<p>231</p> <p>CZK0277145</p> <p>Name : Dr. H. Lalzarliana Father's Name : H. Dailova (L) House Number (Notional) : 69 Age : 52 Gender : Male</p> <p>Photo Available</p>
<p>232</p> <p>CZK0277152</p> <p>Name : A. Lalramngheti Husband's Name : Dr. H. Lalzarliana House Number (Notional) : 69 Age : 51 Gender : Female</p> <p>Photo Available</p>	<p>233</p> <p>RHE0086363</p> <p>Name : Lalkhawngaihduhsaka Father's Name : Dr.H.Lalzarliana House Number (Notional) : 69 Age : 22 Gender : Male</p> <p>Photo Available</p>	<p>234</p> <p>LXK0056697</p> <p>Name : Zoliana Khiangte Father's Name : K. C. Lalhmuaka House Number (Notional) : 70 Age : 50 Gender : Male</p> <p>Photo Available</p>
<p>235</p> <p>LXK0057208</p> <p>Name : F. Thangrimawii Husband's Name : Zoliana Khiangte House Number (Notional) : 70 Age : 50 Gender : Female</p> <p>Photo Available</p>	<p>236</p> <p>RHE0020404</p> <p>Name : Lalbiaknii Khiangte Father's Name : Zoliana Khiangte House Number (Notional) : 70 Age : 32 Gender : Female</p> <p>Photo Available</p>	<p>237</p> <p>RHE0024216</p> <p>Name : Lalhriatpuii Khiangte Father's Name : Zoliana Khiangte House Number (Notional) : 70 Age : 31 Gender : Female</p> <p>Photo Available</p>
<p>238</p> <p>RHE0052910</p> <p>Name : Lalrinpuia Khiangte Father's Name : Zoliana Khiangte House Number (Notional) : 70 Age : 27 Gender : Male</p> <p>Photo Available</p>	<p>239</p> <p>MRC0035238</p> <p>Name : V. Lalhmangaihi Father's Name : V. Ramlilana House Number (Notional) : 71 Age : 41 Gender : Female</p> <p>Photo Available</p>	<p>240</p> <p>LXK0212886</p> <p>Name : V. Lalremruati Father's Name : V. Ramlilana House Number (Notional) : 71 Age : 33 Gender : Female</p> <p>Photo Available</p>

<p>241</p> <p>SSZ0063420</p> <p>Name : C. Malsawmzuali Father's Name : C. Lalnunsiamia House Number (Notional) : 71 Age : 24 Gender : Female</p> <p>Photo Available</p>	<p>242</p> <p>RHE0082453</p> <p>Name : Zonunsanga Father's Name : Hunlawmawma (L) House Number (Notional) : 71 Age : 23 Gender : Male</p> <p>Photo Available</p>	<p>243</p> <p>YRY0014134</p> <p>Name : Zodinsanga Father's Name : Lalbiaklawma House Number (Notional) : 72 Age : 36 Gender : Male</p> <p>Photo Available</p>
<p>244</p> <p>RHE0037523</p> <p>Name : Centenary Lalhriatpuii Father's Name : Lalmalsawma House Number (Notional) : 72 Age : 29 Gender : Female</p> <p>Photo Available</p>	<p>245</p> <p>LXK0235499</p> <p>Name : Vanlaipeki Husband's Name : P. C. Vanlaltiana House Number (Notional) : 73 Age : 33 Gender : Female</p> <p>Photo Available</p>	<p>246</p> <p>NJP0000828</p> <p>Name : Vanlailiana Father's Name : Thanghlira House Number (Notional) : 74 Age : 72 Gender : Male</p> <p>Photo Available</p>
<p>247</p> <p>LXK0138297</p> <p>Name : Ramzawni Husband's Name : Vanlailiana House Number (Notional) : 74 Age : 66 Gender : Female</p> <p>Photo Available</p>	<p>248</p> <p>LXK0138594</p> <p>Name : Lalremruata Father's Name : Vanlailiana House Number (Notional) : 74 Age : 37 Gender : Male</p> <p>Photo Available</p>	<p>249</p> <p>RHE0093518</p> <p>Name : Laldinsanga Father's Name : Lalremruata House Number (Notional) : 74 Age : 21 Gender : Male</p> <p>Photo Available</p>
<p>250</p> <p>LXK0212746</p> <p>Name : Lalmuanpuia Father's Name : Zabuanga House Number (Notional) : 75 Age : 39 Gender : Male</p> <p>Photo Available</p>	<p>251</p> <p>LXK0255760</p> <p>Name : Zailanthanga Father's Name : Zabuanga House Number (Notional) : 75 Age : 34 Gender : Male</p> <p>Photo Available</p>	<p>252</p> <p>LXK0235580</p> <p>Name : H. S. Lallawmsanga Father's Name : Zabuanga House Number (Notional) : 75 Age : 35 Gender : Male</p> <p>Photo Available</p>
<p>253</p> <p>LXK0255729</p> <p>Name : R. K. Lalnuntluangi Husband's Name : Lalmuanpuia House Number (Notional) : 75 Age : 32 Gender : Female</p> <p>Photo Available</p>	<p>254</p> <p>NXQ0034884</p> <p>Name : Lalchhanchuahi Father's Name : Sangmawia House Number (Notional) : 75 Age : 29 Gender : Female</p> <p>Photo Available</p>	<p>255</p> <p>BPD0019695</p> <p>Name : B. Sanga Father's Name : Budhwa Sanga House Number (Notional) : 76 Age : 70 Gender : Male</p> <p>Photo Available</p>
<p>256</p> <p>LXK0213033</p> <p>Name : John Nghakliana Rokhum Father's Name : Lalringa House Number (Notional) : 76 Age : 57 Gender : Male</p> <p>Photo Available</p>	<p>257</p> <p>LXK0212936</p> <p>Name : Darchhungi Husband's Name : John Nghakliana Rokhum House Number (Notional) : 76 Age : 58 Gender : Female</p> <p>Photo Available</p>	<p>258</p> <p>LXK0235465</p> <p>Name : R. K. Hmingthansanga Father's Name : John Nghakliana Rokhum House Number (Notional) : 76 Age : 37 Gender : Male</p> <p>Photo Available</p>
<p>259</p> <p>LXK0213207</p> <p>Name : R. K. Rosangpuii Father's Name : John Nghakliana Rokhum House Number (Notional) : 76 Age : 36 Gender : Female</p> <p>Photo Available</p>	<p>260</p> <p>LXK0213199</p> <p>Name : R. K. Lalchhanhima Father's Name : John Nghakliana Rokhum House Number (Notional) : 76 Age : 33 Gender : Male</p> <p>Photo Available</p>	<p>261</p> <p>RHE0029918</p> <p>Name : R. K. Lalduhkima Father's Name : John Nghakliana Rokhum House Number (Notional) : 76 Age : 33 Gender : Male</p> <p>Photo Available</p>
<p>262</p> <p>LXK0055624</p> <p>Name : Zohmangaihi Father's Name : Sangzuala (L) House Number (Notional) : 77 Age : 59 Gender : Female</p> <p>Photo Available</p>	<p>263</p> <p>LXK0055277</p> <p>Name : Lallawmzuala Father's Name : Zabuanga House Number (Notional) : 77 Age : 43 Gender : Male</p> <p>Photo Available</p>	<p>264</p> <p>RHE0052902</p> <p>Name : R. Lalnunchami Mother's Name : Zohmangaihi House Number (Notional) : 77 Age : 28 Gender : Female</p> <p>Photo Available</p>
<p>265</p> <p>RHE0086371</p> <p>Name : Vanlaipeka Father's Name : Lallawmzuala House Number (Notional) : 77 Age : 22 Gender : Male</p> <p>Photo Available</p>	<p>266</p> <p>LXK0057539</p> <p>Name : H. Sapchawna Father's Name : Ngulzinga (L) House Number (Notional) : 78 Age : 65 Gender : Male</p> <p>Photo Available</p>	<p>267</p> <p>LXK0057547</p> <p>Name : Ramengzauvi Husband's Name : H. Sapchawna House Number (Notional) : 78 Age : 57 Gender : Female</p> <p>Photo Available</p>
<p>268</p> <p>LXK0212878</p> <p>Name : H. Robuanga Father's Name : Haupianga (L) House Number (Notional) : 79 Age : 54 Gender : Male</p> <p>Photo Available</p>	<p>269</p> <p>LXK0212928</p> <p>Name : Lalsiamliani Sailo Husband's Name : H. Robuanga House Number (Notional) : 79 Age : 45 Gender : Female</p> <p>Photo Available</p>	<p>270</p> <p>RHE0058743</p> <p>Name : Lalrawngbawla Father's Name : H. Robuanga House Number (Notional) : 79 Age : 26 Gender : Male</p> <p>Photo Available</p>

<p>271</p> <p>RHE0063511</p> <p>Name : Disciple Ramdinsanga Father's Name : H. Robuanga House Number (Notional) : 79 Age : 25 Gender : Male</p> <p>Photo Available</p>	<p>272</p> <p>RHE0082446</p> <p>Name : Zaitinremi Father's Name : H. Robuanga House Number (Notional) : 79 Age : 23 Gender : Female</p> <p>Photo Available</p>	<p>273</p> <p>RHE0071506</p> <p>Name : Lalnuntluangi Father's Name : Vanlalsawma House Number (Notional) : 79 Age : 24 Gender : Female</p> <p>Photo Available</p>
<p>274</p> <p>RHE0093534</p> <p>Name : Zoramuanpuia Father's Name : Robuanga House Number (Notional) : 79 Age : 21 Gender : Male</p> <p>Photo Available</p>	<p>275</p> <p>LXK0097360</p> <p>Name : Ngurkhuma Mother's Name : Zamawii House Number (Notional) : 80 Age : 53 Gender : Male</p> <p>Photo Available</p>	<p>276</p> <p>LXK0219444</p> <p>Name : Lalremsiami Husband's Name : Ngurkhuma House Number (Notional) : 80 Age : 50 Gender : Female</p> <p>Photo Available</p>
<p>277</p> <p>RHE0046169</p> <p>Name : Lalinghatzova Father's Name : Ringliana House Number (Notional) : 80 Age : 29 Gender : Male</p> <p>Photo Available</p>	<p>278</p> <p>RHE0086389</p> <p>Name : P.C.Lalruatpuii Father's Name : C.Ngurkhuma House Number (Notional) : 80 Age : 22 Gender : Female</p> <p>Photo Available</p>	<p>279</p> <p>RHE0104356</p> <p>Name : Lalpekhui Father's Name : Ngurkhuma House Number (Notional) : 80 Age : 20 Gender : Female</p> <p>Photo Available</p>
<p>280</p> <p>NJP0008664</p> <p>Name : Zopari Father's Name : Siamliana House Number (Notional) : 81 Age : 51 Gender : Female</p> <p>Photo Available</p>	<p>281</p> <p>JTB0187450</p> <p>Name : Romawia Father's Name : Lalinghinglova House Number (Notional) : 82 Age : 58 Gender : Male</p> <p>Photo Available</p>	<p>282</p> <p>JTB0187443</p> <p>Name : Lalhlupuii Husband's Name : Romawia House Number (Notional) : 82 Age : 49 Gender : Female</p> <p>Photo Available</p>
<p>283</p> <p>NSM0009787</p> <p>Name : Lalrinchhana Father's Name : Romawia House Number (Notional) : 82 Age : 31 Gender : Male</p> <p>Photo Available</p>	<p>284</p> <p>RHE0037531</p> <p>Name : Malsawmdawngzeli Father's Name : Romawia House Number (Notional) : 82 Age : 29 Gender : Female</p> <p>Photo Available</p>	<p>285</p> <p>RHE0058776</p> <p>Name : Rebek Lallawmzuali Father's Name : Romawia House Number (Notional) : 82 Age : 29 Gender : Female</p> <p>Photo Available</p>
<p>286</p> <p>RHE0063578</p> <p>Name : Lalhmingangi Father's Name : Romawia House Number (Notional) : 82 Age : 26 Gender : Female</p> <p>Photo Available</p>	<p>287</p> <p>LXK0055590</p> <p>Name : R. Zohmangaiha Father's Name : R. Rualzachinga (L) House Number (Notional) : 83 Age : 60 Gender : Male</p> <p>Photo Available</p>	<p>288</p> <p>LXK0055582</p> <p>Name : Daisy Lalremruati Husband's Name : R. Zohmangaiha House Number (Notional) : 83 Age : 49 Gender : Female</p> <p>Photo Available</p>
<p>289</p> <p>RHE0006155</p> <p>Name : Zorinliani Father's Name : R. Zohmangaiha House Number (Notional) : 83 Age : 33 Gender : Female</p> <p>Photo Available</p>	<p>290</p> <p>RHE0007310</p> <p>Name : Zochhuani Renthlei Father's Name : R. Zohmangaiha House Number (Notional) : 83 Age : 32 Gender : Female</p> <p>Photo Available</p>	<p>291</p> <p>RHE0020388</p> <p>Name : Zohlunchhungi Renthlei Father's Name : R. Zohmangaiha House Number (Notional) : 83 Age : 32 Gender : Female</p> <p>Photo Available</p>
<p>292</p> <p>NSM0020164</p> <p>Name : K. Lalmuanawmi Husband's Name : Benjamin Zoduhzuala House Number (Notional) : 83 Age : 31 Gender : Female</p> <p>Photo Available</p>	<p>293</p> <p>RHE0037481</p> <p>Name : Benjamin Zoduhzuala Father's Name : R. Zohmangaiha House Number (Notional) : 83 Age : 29 Gender : Male</p> <p>Photo Available</p>	<p>294</p> <p>MYV0048538</p> <p>Name : Saizika Sailo Father's Name : Liankhuma House Number (Notional) : 84 Age : 66 Gender : Male</p> <p>Photo Available</p>
<p>295</p> <p>MYV0048546</p> <p>Name : Lailuitluangi Husband's Name : Saizika House Number (Notional) : 84 Age : 61 Gender : Female</p> <p>Photo Available</p>	<p>296</p> <p>RHE0102103</p> <p>Name : Vanlalhriata Sailo Father's Name : Saizika Sailo House Number (Notional) : 84 Age : 20 Gender : Male</p> <p>Photo Available</p>	<p>297</p> <p>RHE0093450</p> <p>Name : Joseph Singh Father's Name : Samdyal Singh House Number (Notional) : 85 Age : 24 Gender : Male</p> <p>Photo Available</p>
<p>298</p> <p>CDN0150490</p> <p>Name : Neihchhungi Father's Name : Sangzuala House Number (Notional) : 86 Age : 64 Gender : Female</p> <p>Photo Available</p>	<p>299</p> <p>RHE0103770</p> <p>Name : Pankaj Dey Father's Name : Paresh Dey House Number (Notional) : 86 Age : 60 Gender : Male</p> <p>Photo Available</p>	<p>300</p> <p>YRY0048280</p> <p>Name : Jerry Lalawmpuia Father's Name : P.K. Dey House Number (Notional) : 86 Age : 35 Gender : Male</p> <p>Photo Available</p>

<p>301</p> <p>YRY0048298</p> <p>Name : Malsawmzuali Father's Name : P.K. Dey House Number (Notional) : 86 Age : 31 Gender : Female</p> <p>Photo Available</p>	<p>302</p> <p>LXK0039156</p> <p>Name : C. Thanzami Husband's Name : T. Tlanhmingthanga House Number (Notional) : 87 Age : 61 Gender : Female</p> <p>Photo Available</p>	<p>303</p> <p>LXK0039164</p> <p>Name : T. Tlanhmingthanga Father's Name : Thangnawna House Number (Notional) : 87 Age : 60 Gender : Male</p> <p>Photo Available</p>
<p>304</p> <p>LXK0260356</p> <p>Name : Loisy Vanlalmuanpui Father's Name : T.H. Thanga House Number (Notional) : 87 Age : 37 Gender : Female</p> <p>Photo Available</p>	<p>305</p> <p>UGN0022269</p> <p>Name : Joseph T. Lalfakzuala Father's Name : T. Tlanhmingthanga House Number (Notional) : 87 Age : 33 Gender : Male</p> <p>Photo Available</p>	<p>306</p> <p>UGN0022244</p> <p>Name : Irene V. L. Tuallawt Father's Name : T. Tlanhmingthanga House Number (Notional) : 87 Age : 31 Gender : Female</p> <p>Photo Available</p>
<p>307</p> <p>UGN0035527</p> <p>Name : Vanlalmalsawmi Father's Name : T. Tlanhmingthanga House Number (Notional) : 87 Age : 29 Gender : Female</p> <p>Photo Available</p>	<p>308</p> <p>LFL0050120</p> <p>Name : Lalengkima Mother's Name : Lalthianghlimi House Number (Notional) : 88 Age : 44 Gender : Male</p> <p>Photo Available</p>	<p>309</p> <p>LFL0083485</p> <p>Name : Diana Zodinpui Father's Name : Vanlalpeka House Number (Notional) : 88 Age : 39 Gender : Female</p> <p>Photo Available</p>
<p>310</p> <p>RHE0101915</p> <p>Name : Depali Kumari Father's Name : Samdyal Singh House Number (Notional) : 89 Age : 22 Gender : Female</p> <p>Photo Available</p>	<p>311</p> <p>RHE0101923</p> <p>Name : Anurag Saikia Father's Name : Prasanta Saikia House Number (Notional) : 90 Age : 20 Gender : Male</p> <p>Photo Available</p>	<p>312</p> <p>RHE0005579</p> <p>Name : Dr. Bedanga Konwar Father's Name : Rohiteswar Konwar (L) House Number (Notional) : 91 Age : 50 Gender : Male</p> <p>Photo Available</p>
<p>313</p> <p>RHE0005256</p> <p>Name : Rupanjali Konwar Husband's Name : Dr. Bedanga Konwar House Number (Notional) : 91 Age : 44 Gender : Female</p> <p>Photo Available</p>	<p>314</p> <p>RHE0104620</p> <p>Name : Ananya Konwar Father's Name : Dr. Badanga Konwar House Number (Notional) : 91 Age : 20 Gender : Female</p> <p>Photo Available</p>	<p>315</p> <p>WTT0055566</p> <p>Name : Malsawmfawnvela Father's Name : Lalchhandama House Number (Notional) : 92 Age : 28 Gender : Male</p> <p>Photo Available</p>
<p>316</p> <p>ACH0045708</p> <p>Name : Lalringgheti Father's Name : Kapkunga House Number (Notional) : 93 Age : 33 Gender : Female</p> <p>Photo Available</p>	<p>317</p> <p>BPD0078956</p> <p>Name : Vanlalghaki Husband's Name : S. L. Khama House Number (Notional) : 94 Age : 59 Gender : Female</p> <p>Photo Available</p>	<p>318</p> <p>BPD0310706</p> <p>Name : Ngurengmawia Sailo Father's Name : S. L. Khama House Number (Notional) : 94 Age : 34 Gender : Male</p> <p>Photo Available</p>
<p>319</p> <p>RHE0013862</p> <p>Name : Saihmingliana Sailo Father's Name : S. L. Khama House Number (Notional) : 94 Age : 32 Gender : Male</p> <p>Photo Available</p>	<p>320</p> <p>GDP0253583</p> <p>Name : Vanthuama Father's Name : Ramfangzauva House Number (Notional) : 95 Age : 70 Gender : Male</p> <p>Photo Available</p>	<p>321</p> <p>RHE0113621</p> <p>Name : Puja Kumari Father's Name : Sarban Kumar Prasad House Number (Notional) : 96 Age : 22 Gender : Female</p> <p>Photo Available</p>
<p>322</p> <p>RHE0113613</p> <p>Name : Ishmriti Kumari Father's Name : Sarban Kumar Prasad House Number (Notional) : 96 Age : 20 Gender : Female</p> <p>Photo Available</p>	<p>323</p> <p>RHE0114504</p> <p>Name : Laldinmawia Mother's Name : H Lalchuanmawii House Number (Notional) : 6 Age : 18 Gender : Male</p> <p>Photo Available</p>	<p>324</p> <p>RHE0115006</p> <p>Name : Laltiankima Father's Name : H Lalruatkima House Number (Notional) : 1 Age : 18 Gender : Male</p> <p>Photo Available</p>
<p>325</p> <p>RHE0117291</p> <p>Name : Lalhmudiki Tuallawt Father's Name : Lalthanmawia House Number (Notional) : 38 Age : 18 Gender : Female</p> <p>Photo Available</p>	<p>326</p> <p>RHE0117309</p> <p>Name : C Lalrinzuala Mother's Name : H Lalduhzuali House Number (Notional) : 47 Age : 18 Gender : Male</p> <p>Photo Available</p>	<p>327</p> <p>RHE0117630</p> <p>Name : K Lalremliana Father's Name : Lalbiakvela House Number (Notional) : 91 Age : 18 Gender : Male</p> <p>Photo Available</p>
<p>328</p> <p>RHE0117655</p> <p>Name : Govind Rana Father's Name : Rambahadur Rana House Number (Notional) : 29 Age : 18 Gender : Male</p> <p>Photo Available</p>	<p>329</p> <p>RHE0117663</p> <p>Name : K Lalruatfela Father's Name : K Lalremmawia House Number (Notional) : 19 Age : 18 Gender : Male</p> <p>Photo Available</p>	<p>330</p> <p>RHE0117697</p> <p>Name : Ambika Prasad Father's Name : Hridayesh Prasad House Number (Notional) : 61 Age : 20 Gender : Female</p> <p>Photo Available</p>

331

RHE0117705

Name : Vanlalmuanpui Ralte
Father's Name : R Lalbiakmawia
House Number (Notional) : 25
Age : 19 Gender : Female



<p>332</p> <p>Name : Lalhmgaihzaui Father's Name : Saiphung(L) House Number (Notional) : 1 Age : 56 Gender : Female</p> <p>JDF0025130</p> <p>Photo</p> <p>Available</p>	<p>333</p> <p>Name : Zoramsiamthanga Father's Name : Zoramnginghiana House Number (Notional) : 1 Age : 38 Gender : Male</p> <p>JDF0281386</p> <p>Photo</p> <p>Available</p>	<p>334</p> <p>Name : P. C. Lalruatfeli Husband's Name : Zoramsiamthanga House Number (Notional) : 1 Age : 38 Gender : Female</p> <p>HNV0180083</p> <p>Photo</p> <p>Available</p>
<p>335</p> <p>Name : Vanlaimaisawmdawnglana Father's Name : Lalbiakhara House Number (Notional) : 2 Age : 44 Gender : Male</p> <p>RHE0020420</p> <p>Photo</p> <p>Available</p>	<p>336</p> <p>Name : F. Thangkumi Husband's Name : Laitlina Sailo House Number (Notional) : 3 Age : 81 Gender : Female</p> <p>LXK0056630</p> <p>Photo</p> <p>Available</p>	<p>337</p> <p>Name : Laidinpuia Madina Father's Name : Laitlina House Number (Notional) : 3 Age : 58 Gender : Male</p> <p>LXK0170514</p> <p>Photo</p> <p>Available</p>
<p>338</p> <p>Name : Saidingpuii Sailo Father's Name : Laitlina Sailo House Number (Notional) : 3 Age : 47 Gender : Female</p> <p>LXK0056663</p> <p>Photo</p> <p>Available</p>	<p>339</p> <p>Name : Lalruatfeli Father's Name : C. Chhuanvavra House Number (Notional) : 3 Age : 39 Gender : Female</p> <p>LXK0059881</p> <p>Photo</p> <p>Available</p>	<p>340</p> <p>Name : Jerry Lalriliiana Father's Name : Rallianthanga House Number (Notional) : 4 Age : 43 Gender : Male</p> <p>LXK0055970</p> <p>Photo</p> <p>Available</p>
<p>341</p> <p>Name : Lalnunfeli Husband's Name : Jerry Lalriliiana House Number (Notional) : 4 Age : 33 Gender : Female</p> <p>LXK0039776</p> <p>Photo</p> <p>Available</p>	<p>342</p> <p>Name : L. B. Chawimawia Father's Name : Lalsiamliana (L) House Number (Notional) : 5 Age : 54 Gender : Male</p> <p>LXK0057729</p> <p>Photo</p> <p>Available</p>	<p>343</p> <p>Name : Vanlahruaii Husband's Name : L. B. Chawimawia House Number (Notional) : 5 Age : 54 Gender : Female</p> <p>LXK0056077</p> <p>Photo</p> <p>Available</p>
<p>344</p> <p>Name : Lalhminghlui Sailo Father's Name : L. B. Chawimawia House Number (Notional) : 5 Age : 32 Gender : Female</p> <p>RHE0020370</p> <p>Photo</p> <p>Available</p>	<p>345</p> <p>Name : Lalremtluangi Father's Name : L. B. Chawimawia House Number (Notional) : 5 Age : 30 Gender : Female</p> <p>RHE0011692</p> <p>Photo</p> <p>Available</p>	<p>346</p> <p>Name : Lalparliani Sailo Father's Name : L. B. Chawimawia House Number (Notional) : 5 Age : 26 Gender : Female</p> <p>RHE0058735</p> <p>Photo</p> <p>Available</p>
<p>347</p> <p>Name : Lalthankima Father's Name : Tlangthanpara House Number (Notional) : 6 Age : 45 Gender : Male</p> <p>LXK0258566</p> <p>Photo</p> <p>Available</p>	<p>348</p> <p>Name : C. Lalrokimi Husband's Name : Lalthankima House Number (Notional) : 6 Age : 43 Gender : Female</p> <p>JDF0167411</p> <p>Photo</p> <p>Available</p>	<p>349</p> <p>Name : Zuihangi Husband's Name : Lalrosanga House Number (Notional) : 7 Age : 66 Gender : Female</p> <p>LXK0056747</p> <p>Photo</p> <p>Available</p>
<p>350</p> <p>Name : C Lalrinchhuanga Father's Name : C Lalrosanga House Number (Notional) : 7 Age : 39 Gender : Male</p> <p>LXK0059923</p> <p>Photo</p> <p>Available</p>	<p>351</p> <p>Name : C. Lalmuanpuii Father's Name : Lalrosanga House Number (Notional) : 7 Age : 33 Gender : Female</p> <p>LXK0213363</p> <p>Photo</p> <p>Available</p>	<p>352</p> <p>Name : C. Zodinpuui Father's Name : C. Thanmawia House Number (Notional) : 7 Age : 23 Gender : Female</p> <p>RHE0082438</p> <p>Photo</p> <p>Available</p>
<p>353</p> <p>Name : Lalveni Husband's Name : Vanzika House Number (Notional) : 8 Age : 69 Gender : Female</p> <p>LXK0213330</p> <p>Photo</p> <p>Available</p>	<p>354</p> <p>Name : Vanzika Father's Name : Rinthanga (L) House Number (Notional) : 8 Age : 61 Gender : Male</p> <p>LXK0213223</p> <p>Photo</p> <p>Available</p>	<p>355</p> <p>Name : Zonunmawia Father's Name : Vanzika House Number (Notional) : 8 Age : 42 Gender : Male</p> <p>LXK0055905</p> <p>Photo</p> <p>Available</p>
<p>356</p> <p>Name : R. Lalhmunmawii Father's Name : Vanzika House Number (Notional) : 8 Age : 36 Gender : Female</p> <p>LXK0213355</p> <p>Photo</p> <p>Available</p>	<p>357</p> <p>Name : R. Lalrinhlui Father's Name : Vanzika House Number (Notional) : 8 Age : 35 Gender : Female</p> <p>LXK0213348</p> <p>Photo</p> <p>Available</p>	<p>358</p> <p>Name : Lalbiakzuali Father's Name : Vanenga House Number (Notional) : 8 Age : 31 Gender : Female</p> <p>TXB0068502</p> <p>Photo</p> <p>Available</p>
<p>359</p> <p>Name : C. Vanlalhluana Father's Name : Lalthiluma House Number (Notional) : 9 Age : 50 Gender : Male</p> <p>LXK0057596</p> <p>Photo</p> <p>Available</p>	<p>360</p> <p>Name : Lalsangpuii Husband's Name : C. Vanlalhluana House Number (Notional) : 9 Age : 49 Gender : Female</p> <p>LXK0057604</p> <p>Photo</p> <p>Available</p>	<p>361</p> <p>Name : Vanlalkrosamawia Father's Name : Vanlalhluana House Number (Notional) : 9 Age : 30 Gender : Male</p> <p>RHE0011684</p> <p>Photo</p> <p>Available</p>

<p>362</p> <p>RHE0029892</p> <p>Name : Lalduatpuii Father's Name : C. Vanlalhluna House Number (Notional) : 9 Age : 30 Gender : Female</p> <p>Photo Available</p>	<p>363</p> <p>RHE0048512</p> <p>Name : C. Ramthamghaki Father's Name : C. Vanlalhluna House Number (Notional) : 9 Age : 28 Gender : Female</p> <p>Photo Available</p>	<p>364</p> <p>LXK0056689</p> <p>Name : Lalthansanga Father's Name : Taichhunga House Number (Notional) : 10 Age : 63 Gender : Male</p> <p>Photo Available</p>
<p>365</p> <p>LXK0056671</p> <p>Name : C. C. Thangi Husband's Name : Lalthansanga House Number (Notional) : 10 Age : 61 Gender : Female</p> <p>Photo Available</p>	<p>366</p> <p>LXK0212993</p> <p>Name : Lalfelfamkima Father's Name : Lalthansanga House Number (Notional) : 10 Age : 35 Gender : Male</p> <p>Photo Available</p>	<p>367</p> <p>RHE0020321</p> <p>Name : Lalthangmawia Father's Name : Lalthansanga House Number (Notional) : 10 Age : 32 Gender : Male</p> <p>Photo Available</p>
<p>368</p> <p>RHE0048488</p> <p>Name : Vanlalawmpuia Father's Name : Lalthansanga House Number (Notional) : 10 Age : 28 Gender : Male</p> <p>Photo Available</p>	<p>369</p> <p>LXK0056184</p> <p>Name : Lalzami Husband's Name : Vanlalhmuaka House Number (Notional) : 11 Age : 53 Gender : Female</p> <p>Photo Available</p>	<p>370</p> <p>LXK0056655</p> <p>Name : Vanlalhmuaka Father's Name : Khuanga (L) House Number (Notional) : 11 Age : 49 Gender : Male</p> <p>Photo Available</p>
<p>371</p> <p>LXK0235515</p> <p>Name : Lalawmzuaili Father's Name : Vanlalhmuaka House Number (Notional) : 11 Age : 29 Gender : Female</p> <p>Photo Available</p>	<p>372</p> <p>RHE0011700</p> <p>Name : Lalthasanga Father's Name : Vanlalhmuaka House Number (Notional) : 11 Age : 30 Gender : Male</p> <p>Photo Available</p>	<p>373</p> <p>RHE0102079</p> <p>Name : Lalhminganga Father's Name : Jeep Lala House Number (Notional) : 11 Age : 20 Gender : Male</p> <p>Photo Available</p>
<p>374</p> <p>LXK0176867</p> <p>Name : Lalthanpuii Husband's Name : F. Chhuanthanga House Number (Notional) : 12 Age : 57 Gender : Female</p> <p>Photo Available</p>	<p>375</p> <p>LXK0179812</p> <p>Name : F. Saithangpuia Father's Name : F. Chhuanthanga House Number (Notional) : 12 Age : 41 Gender : Male</p> <p>Photo Available</p>	<p>376</p> <p>LXK0114207</p> <p>Name : Lalrinengi Husband's Name : Saithangpuia House Number (Notional) : 12 Age : 41 Gender : Female</p> <p>Photo Available</p>
<p>377</p> <p>RHE0103457</p> <p>Name : F. Lalrindiki Father's Name : F. Saithangpuia House Number (Notional) : 12 Age : 20 Gender : Female</p> <p>Photo Available</p>	<p>378</p> <p>MYV0179622</p> <p>Name : Lalzahawmi Father's Name : Lalthlamuana House Number (Notional) : 13 Age : 35 Gender : Female</p> <p>Photo Available</p>	<p>379</p> <p>LXK0213181</p> <p>Name : Lalhmingahzuala Father's Name : P. Lala House Number (Notional) : 13 Age : 34 Gender : Male</p> <p>Photo Available</p>
<p>380</p> <p>LXK0056739</p> <p>Name : C lalhuthangi Husband's Name : C. Vanthuamluaia House Number (Notional) : 14 Age : 65 Gender : Female</p> <p>Photo Available</p>	<p>381</p> <p>LXK0055996</p> <p>Name : C. Zingengmawii Father's Name : C. Vanthuamluaia House Number (Notional) : 14 Age : 45 Gender : Female</p> <p>Photo Available</p>	<p>382</p> <p>LXK0056846</p> <p>Name : Mosi Lalremruata Father's Name : C. Vanthuamluaia House Number (Notional) : 14 Age : 41 Gender : Male</p> <p>Photo Available</p>
<p>383</p> <p>LXK0059899</p> <p>Name : C. Lalenkawli Father's Name : C. Vanthuamluaia House Number (Notional) : 14 Age : 39 Gender : Female</p> <p>Photo Available</p>	<p>384</p> <p>RHE0029900</p> <p>Name : Joseph Lalhriatpuia Father's Name : Laldingliana House Number (Notional) : 14 Age : 32 Gender : Male</p> <p>Photo Available</p>	<p>385</p> <p>LXK0055657</p> <p>Name : Lalrotluangi Husband's Name : C. Lalnelawma House Number (Notional) : 15 Age : 43 Gender : Female</p> <p>Photo Available</p>
<p>386</p> <p>LXK0055822</p> <p>Name : C. Lalnelawma Father's Name : Lalrosanga House Number (Notional) : 15 Age : 42 Gender : Male</p> <p>Photo Available</p>	<p>387</p> <p>RHE0082420</p> <p>Name : Ricky Lalramnghaka Father's Name : C. Lalnelawma House Number (Notional) : 15 Age : 23 Gender : Male</p> <p>Photo Available</p>	<p>388</p> <p>RHE0108316</p> <p>Name : C. Lalruatdiki Father's Name : C. Lalnelawma House Number (Notional) : 15 Age : 19 Gender : Female</p> <p>Photo Available</p>
<p>389</p> <p>LXK0235531</p> <p>Name : H.C. Lalthafela Father's Name : H.C. Lalchharliana (L) House Number (Notional) : 16 Age : 35 Gender : Male</p> <p>Photo Available</p>	<p>390</p> <p>LXK0212738</p> <p>Name : R. Lalrinpuii Father's Name : Ramhmuzauva House Number (Notional) : 16 Age : 32 Gender : Female</p> <p>Photo Available</p>	<p>391</p> <p>LXK0055483</p> <p>Name : Lalfakzuala Father's Name : Lalzawmliana (L) House Number (Notional) : 17 Age : 48 Gender : Male</p> <p>Photo Available</p>

<p>392</p> <p>Name : Lalremruati Zote Husband's Name: Lalfakzuala House Number (Notional) : 17 Age : 45 Gender : Female</p> <p>Photo Available</p>	LXK0057166	<p>393</p> <p>Name : Zodinpuii Father's Name: Lalfakzuala House Number (Notional) : 17 Age : 25 Gender : Female</p> <p>Photo Available</p>	RHE0063495	<p>394</p> <p>Name : Emmanuel Lahunluanga Father's Name: Lalfakzuala House Number (Notional) : 17 Age : 24 Gender : Male</p> <p>Photo Available</p>	RHE0070839
<p>395</p> <p>Name : Malsawmdawngliana Father's Name: Lalfakzuala House Number (Notional) : 17 Age : 20 Gender : Male</p> <p>Photo Available</p>	RHE0101899	<p>396</p> <p>Name : K. Laichhanhimi Husband's Name: P. C. Zohmingthanga House Number (Notional) : 18 Age : 41 Gender : Female</p> <p>Photo Available</p>	LHM0025486	<p>397</p> <p>Name : P. C. Zohmingthanga Father's Name: Ngurbiakthanga House Number (Notional) : 18 Age : 39 Gender : Male</p> <p>Photo Available</p>	LXK0056804
<p>398</p> <p>Name : H. C. Lalhriatpuia Father's Name: Lalrinpuia House Number (Notional) : 19 Age : 53 Gender : Male</p> <p>Photo Available</p>	KDJ0002592	<p>399</p> <p>Name : Ngurthanzami Husband's Name: H. C. Lalhriatpuia House Number (Notional) : 19 Age : 50 Gender : Female</p> <p>Photo Available</p>	KDJ0002220	<p>400</p> <p>Name : Christy Lalbiakdiki Father's Name: H. C. Lalhriatpuia House Number (Notional) : 19 Age : 24 Gender : Female</p> <p>Photo Available</p>	RHE0075309
<p>401</p> <p>Name : Priscilla Zonunmawii Father's Name: H.C. lalhriatpuia House Number (Notional) : 19 Age : 21 Gender : Female</p> <p>Photo Available</p>	RHE0093526	<p>402</p> <p>Name : Laltlanthangi Father's Name: Ngurchhawna House Number (Notional) : 20 Age : 44 Gender : Female</p> <p>Photo Available</p>	LXK0142174	<p>403</p> <p>Name : Lalfakawma Father's Name: Rothangvunga House Number (Notional) : 21 Age : 52 Gender : Male</p> <p>Photo Available</p>	LXK0213231
<p>404</p> <p>Name : Lalrinpuii Husband's Name: Lalfakawma House Number (Notional) : 21 Age : 40 Gender : Female</p> <p>Photo Available</p>	LXK0015768	<p>405</p> <p>Name : Laldawngliani Husband's Name: T. C. Lalchhanchhuaha House Number (Notional) : 22 Age : 56 Gender : Female</p> <p>Photo Available</p>	LXK0095356	<p>406</p> <p>Name : T. C. Lalchhanchhuaha Father's Name: Darhmingliana House Number (Notional) : 22 Age : 54 Gender : Male</p> <p>Photo Available</p>	LXK0057505
<p>407</p> <p>Name : T. C. Lalruatkimi Father's Name: T. C. Lalchhanchhuaha House Number (Notional) : 22 Age : 31 Gender : Female</p> <p>Photo Available</p>	RHE0024232	<p>408</p> <p>Name : T. C. Lalhafeli Father's Name: T. C. Lalchhanchhuaha House Number (Notional) : 22 Age : 28 Gender : Female</p> <p>Photo Available</p>	RHE0048579	<p>409</p> <p>Name : T. C. Lallawmkimi Father's Name: T. C. Lalchhanchhuaha House Number (Notional) : 22 Age : 26 Gender : Female</p> <p>Photo Available</p>	RHE0063537
<p>410</p> <p>Name : T. C. Laltanpuia Father's Name: T. C. Lalchhanchhuaha House Number (Notional) : 22 Age : 23 Gender : Male</p> <p>Photo Available</p>	RHE0082479	<p>411</p> <p>Name : R. Lalvilmawii Father's Name: Chipuithanga (L) House Number (Notional) : 23 Age : 72 Gender : Female</p> <p>Photo Available</p>	LXK0057315	<p>412</p> <p>Name : Lalmalsawma Colney Father's Name: Chipuithanga (L) House Number (Notional) : 23 Age : 63 Gender : Male</p> <p>Photo Available</p>	LXK0055913
<p>413</p> <p>Name : Vanrammawii Husband's Name: Lalmalsawma Colney House Number (Notional) : 23 Age : 51 Gender : Female</p> <p>Photo Available</p>	LXK0055921	<p>414</p> <p>Name : Samuel Vanlalpeka Father's Name: Lalmalsawma Colney House Number (Notional) : 23 Age : 29 Gender : Male</p> <p>Photo Available</p>	RHE0037473	<p>415</p> <p>Name : Vanlainglineii Father's Name: Lalmalsawma Colney House Number (Notional) : 23 Age : 27 Gender : Female</p> <p>Photo Available</p>	RHE0052894
<p>416</p> <p>Name : Vanlalremliani Father's Name: Lalmalsawma Colney House Number (Notional) : 23 Age : 25 Gender : Female</p> <p>Photo Available</p>	RHE0063503	<p>417</p> <p>Name : Vanlallawmzualii Father's Name: Lalmalsawma Colney House Number (Notional) : 23 Age : 22 Gender : Female</p> <p>Photo Available</p>	RHE0086447	<p>418</p> <p>Name : R. Lalengliani Father's Name: Zorema House Number (Notional) : 24 Age : 57 Gender : Female</p> <p>Photo Available</p>	LXK0055830
<p>419</p> <p>Name : Annie Laluanpuii Mother's Name: R. Lalengliani House Number (Notional) : 24 Age : 30 Gender : Female</p> <p>Photo Available</p>	RHE0029876	<p>420</p> <p>Name : Benjamin Lalawmpuia Mother's Name: R. Lalengliani House Number (Notional) : 24 Age : 27 Gender : Male</p> <p>Photo Available</p>	RHE0052886	<p>421</p> <p>Name : Daniela Father's Name: C. Lalnghina House Number (Notional) : 25 Age : 45 Gender : Male</p> <p>Photo Available</p>	LXK0213215

<p>422</p> <p>Name : Lalngaihawmi Father's Name : Zabuanga House Number (Notional) : 25 Age : 41 Gender : Female</p> <p>Photo Available</p>	LXK0213009	<p>423</p> <p>Name : C. Lallawmzuala Father's Name : C. Lalnghina House Number (Notional) : 25 Age : 32 Gender : Male</p> <p>Photo Available</p>	RHE0007302	<p>424</p> <p>Name : Ramdinthara Father's Name : Daniela House Number (Notional) : 25 Age : 24 Gender : Male</p> <p>Photo Available</p>	RHE0075325
<p>425</p> <p>Name : Lainunmawia Father's Name : Daniela House Number (Notional) : 25 Age : 21 Gender : Male</p> <p>Photo Available</p>	RHE0093468	<p>426</p> <p>Name : Lalnghakhieli Husband's Name : Vanlalhruaia House Number (Notional) : 26 Age : 48 Gender : Female</p> <p>Photo Available</p>	LXK0057018	<p>427</p> <p>Name : Vanlalhruaia Father's Name : Lianzuala House Number (Notional) : 26 Age : 45 Gender : Male</p> <p>Photo Available</p>	LXK0055319
<p>428</p> <p>Name : Vanlalremruata Father's Name : Vanlalhruaia House Number (Notional) : 26 Age : 31 Gender : Male</p> <p>Photo Available</p>	RHE0024190	<p>429</p> <p>Name : Zosangzuali Father's Name : Vanlalhruaia House Number (Notional) : 26 Age : 30 Gender : Female</p> <p>Photo Available</p>	RHE0029835	<p>430</p> <p>Name : P. C. Lalrammawia Father's Name : P. C. Vanlalhruaia House Number (Notional) : 26 Age : 28 Gender : Male</p> <p>Photo Available</p>	RHE0048454
<p>431</p> <p>Name : P. Lalmalsawma Father's Name : Dokunga House Number (Notional) : 27 Age : 42 Gender : Male</p> <p>Photo Available</p>	RHE0015677	<p>432</p> <p>Name : K.C. Zonunmawii Father's Name : K. Thuamuaia House Number (Notional) : 27 Age : 38 Gender : Female</p> <p>Photo Available</p>	KDJ0184374	<p>433</p> <p>Name : Biakmawii Husband's Name : P. Lalmalsawma House Number (Notional) : 27 Age : 37 Gender : Female</p> <p>Photo Available</p>	LXK0255794
<p>434</p> <p>Name : Esther Lalfeii Father's Name : Dokunga House Number (Notional) : 27 Age : 36 Gender : Female</p> <p>Photo Available</p>	LXK0055012	<p>435</p> <p>Name : Lalthanmawia Father's Name : Dokunga House Number (Notional) : 27 Age : 33 Gender : Male</p> <p>Photo Available</p>	RHE0015669	<p>436</p> <p>Name : Hmingthanliana Father's Name : Sangzuala (L) House Number (Notional) : 28 Age : 54 Gender : Male</p> <p>Photo Available</p>	LXK0055764
<p>437</p> <p>Name : Lalhlirpuii Husband's Name : Hmingthanliana House Number (Notional) : 28 Age : 50 Gender : Female</p> <p>Photo Available</p>	LXK0055772	<p>438</p> <p>Name : H. Lalremruati Father's Name : Hmingthanliana House Number (Notional) : 28 Age : 32 Gender : Female</p> <p>Photo Available</p>	RHE0020313	<p>439</p> <p>Name : Lalhmingthanga Father's Name : Hmingthanliana House Number (Notional) : 28 Age : 30 Gender : Male</p> <p>Photo Available</p>	RHE0029850
<p>440</p> <p>Name : Ricky Lalchawimawia Father's Name : Hmingthanliana House Number (Notional) : 28 Age : 28 Gender : Male</p> <p>Photo Available</p>	RHE0048462	<p>441</p> <p>Name : Lalruatpuii Father's Name : Kapzauva House Number (Notional) : 28 Age : 26 Gender : Female</p> <p>Photo Available</p>	RHE0058768	<p>442</p> <p>Name : H. C. Lalfakawmi Husband's Name : Lalhmingliana House Number (Notional) : 29 Age : 53 Gender : Female</p> <p>Photo Available</p>	LXK0042440
<p>443</p> <p>Name : Lalhmingliana Father's Name : Zahnuna (L) House Number (Notional) : 29 Age : 52 Gender : Male</p> <p>Photo Available</p>	LXK0057497	<p>444</p> <p>Name : Lalrohlua Father's Name : Lalhmingliana House Number (Notional) : 29 Age : 24 Gender : Male</p> <p>Photo Available</p>	RHE0070797	<p>445</p> <p>Name : Laldanglova Hnamte Father's Name : Thangkima (L) House Number (Notional) : 30 Age : 61 Gender : Male</p> <p>Photo Available</p>	LXK0055566
<p>446</p> <p>Name : Lalthakimi Husband's Name : Laldanglova Hnamte House Number (Notional) : 30 Age : 52 Gender : Female</p> <p>Photo Available</p>	LXK0057174	<p>447</p> <p>Name : Lalbiaktluanga Father's Name : Laldanglova Hnamte House Number (Notional) : 30 Age : 32 Gender : Male</p> <p>Photo Available</p>	RHE0011650	<p>448</p> <p>Name : Lainunpua Hnamte Father's Name : Laldanglova Hnamte House Number (Notional) : 30 Age : 30 Gender : Male</p> <p>Photo Available</p>	RHE0029843
<p>449</p> <p>Name : Lalenpuii Father's Name : Laldanglova Hnamte House Number (Notional) : 30 Age : 29 Gender : Female</p> <p>Photo Available</p>	RHE0037465	<p>450</p> <p>Name : Lalthlengliana Father's Name : Laiduhsaka House Number (Notional) : 31 Age : 44 Gender : Male</p> <p>Photo Available</p>	LXK0021535	<p>451</p> <p>Name : Lalthatpuii Husband's Name : Lalthlengliana House Number (Notional) : 31 Age : 35 Gender : Female</p> <p>Photo Available</p>	JTB0200378

<p>452</p> <p>Name : Zodinthara Father's Name : Liankhuma House Number (Notional) : 32 Age : 58 Gender : Male</p> <p>Photo Available</p> <p>LXK0056606</p>	<p>453</p> <p>Name : Thanhiliri Husband's Name : Zodinthara House Number (Notional) : 32 Age : 57 Gender : Female</p> <p>Photo Available</p> <p>LXK0056598</p>	<p>454</p> <p>Name : Lalthanzuala Father's Name : Lianhrima House Number (Notional) : 32 Age : 47 Gender : Male</p> <p>Photo Available</p> <p>MYT0049270</p>
<p>455</p> <p>Name : Nuzawni Father's Name : Vanlalvuana House Number (Notional) : 33 Age : 38 Gender : Female</p> <p>Photo Available</p> <p>LXK0215491</p>	<p>456</p> <p>Name : R Lalbuatsaiha Father's Name : Lalchhanhima House Number (Notional) : 33 Age : 32 Gender : Male</p> <p>Photo Available</p> <p>NJP0052076</p>	<p>457</p> <p>Name : Tinhranga Father's Name : Lianhleia (L) House Number (Notional) : 34 Age : 70 Gender : Male</p> <p>Photo Available</p> <p>MYT0008060</p>
<p>458</p> <p>Name : Ngurthanpuii Husband's Name : Tinhranga House Number (Notional) : 34 Age : 68 Gender : Female</p> <p>Photo Available</p> <p>MYT0008169</p>	<p>S 459</p> <p>Name : Rodinpuia Father's Name : S. Tinhranga House Number (Notional) : 34 Age : 37 Gender : Male</p> <p>Photo Available</p> <p>YGS0011973</p>	<p>460</p> <p>Name : H. Pakunga Father's Name : Zakamlova (L) House Number (Notional) : 35 Age : 81 Gender : Male</p> <p>Photo Available</p> <p>LXK0056457</p>
<p>461</p> <p>Name : Lalrintluangi Husband's Name : H. Pakunga House Number (Notional) : 35 Age : 75 Gender : Female</p> <p>Photo Available</p> <p>LXK0056465</p>	<p>462</p> <p>Name : H. Pazawna Father's Name : H. Pakunga House Number (Notional) : 35 Age : 51 Gender : Male</p> <p>Photo Available</p> <p>LXK0055426</p>	<p>463</p> <p>Name : Lalpakzuali Husband's Name : H. Pazawna House Number (Notional) : 35 Age : 41 Gender : Female</p> <p>Photo Available</p> <p>LXK0054783</p>
<p>464</p> <p>Name : Duhkimi Husband's Name : C. M. S. Dawngzuala House Number (Notional) : 36 Age : 49 Gender : Female</p> <p>Photo Available</p> <p>LXK0056382</p>	<p>465</p> <p>Name : M. S. Dawngzuala Father's Name : C. Vanthuamluia House Number (Notional) : 36 Age : 47 Gender : Male</p> <p>Photo Available</p> <p>RHE0015651</p>	<p>466</p> <p>Name : C.Malsawmkima Father's Name : M.S. Dawngzuala House Number (Notional) : 36 Age : 22 Gender : Male</p> <p>Photo Available</p> <p>RHE0086413</p>
<p>467</p> <p>Name : Sakhawliani Husband's Name : Ramnghinglova House Number (Notional) : 37 Age : 60 Gender : Female</p> <p>Photo Available</p> <p>LXK0057414</p>	<p>468</p> <p>Name : Zodinpuia Father's Name : Ramnghinglova House Number (Notional) : 37 Age : 29 Gender : Male</p> <p>Photo Available</p> <p>LXK0238196</p>	<p>469</p> <p>Name : Zohmingliana Zote Father's Name : Lalrova House Number (Notional) : 38 Age : 53 Gender : Male</p> <p>Photo Available</p> <p>LXK0055061</p>
<p>470</p> <p>Name : R. Lalremruati Husband's Name : Zohmingliana Zote House Number (Notional) : 38 Age : 42 Gender : Female</p> <p>Photo Available</p> <p>MYL0230375</p>	<p>471</p> <p>Name : Malsawmtluanga Zote Father's Name : Zohmingliana Zote House Number (Notional) : 38 Age : 28 Gender : Male</p> <p>Photo Available</p> <p>RHE0048447</p>	<p>472</p> <p>Name : Malsawmzuali Father's Name : Zohmingliana Zote House Number (Notional) : 38 Age : 25 Gender : Female</p> <p>Photo Available</p> <p>RHE0063479</p>
<p>473</p> <p>Name : Zorinpuia Zote Father's Name : Zohmingliana Zote House Number (Notional) : 38 Age : 23 Gender : Male</p> <p>Photo Available</p> <p>RHE0082404</p>	<p>474</p> <p>Name : Kapthluai Husband's Name : Lalsiamliana (L) House Number (Notional) : 39 Age : 90 Gender : Female</p> <p>Photo Available</p> <p>LXK0056242</p>	<p>475</p> <p>Name : Ramhluna Father's Name : Lalsiamliana (L) House Number (Notional) : 39 Age : 65 Gender : Male</p> <p>Photo Available</p> <p>LXK0056473</p>
<p>476</p> <p>Name : Tlanchnuangi Father's Name : Lalsiamliana (L) House Number (Notional) : 39 Age : 58 Gender : Female</p> <p>Photo Available</p> <p>LXK0055863</p>	<p>477</p> <p>Name : R. Lalchhanhimi Husband's Name : Lalramhluna Sailo House Number (Notional) : 39 Age : 57 Gender : Female</p> <p>Photo Available</p> <p>LXK0056259</p>	<p>478</p> <p>Name : Lalhmangalhzuail Sailo Father's Name : Lalramhluna Sailo House Number (Notional) : 39 Age : 36 Gender : Female</p> <p>Photo Available</p> <p>LXK0059956</p>
<p>479</p> <p>Name : Lalmuankima Sailo Father's Name : Lalsiamliana (L) House Number (Notional) : 40 Age : 49 Gender : Male</p> <p>Photo Available</p> <p>LXK0055145</p>	<p>480</p> <p>Name : C. Lalringgheti Husband's Name : Lalmuankima Sailo House Number (Notional) : 40 Age : 45 Gender : Female</p> <p>Photo Available</p> <p>LXK0056333</p>	<p>481</p> <p>Name : David Lalrinkima Sailo Father's Name : Lalmuankima Sailo House Number (Notional) : 40 Age : 23 Gender : Male</p> <p>Photo Available</p> <p>RHE0082859</p>

<p>482</p> <p>RHE0093484</p> <p>Name : Saihmingmawia Sailo Father's Name : Lalmuankima Sailo House Number (Notional) : 40 Age : 21 Gender : Male</p> <p>Photo Available</p>	<p>483</p> <p>RHE0108308</p> <p>Name : Saihlupuii Father's Name : Lalmuankima Sailo House Number (Notional) : 40 Age : 19 Gender : Female</p> <p>Photo Available</p>	<p>484</p> <p>JPQ0036905</p> <p>Name : Lalramhluna Father's Name : Kaithanga (L) House Number (Notional) : 41 Age : 59 Gender : Male</p> <p>Photo Available</p>
<p>485</p> <p>JPQ0037630</p> <p>Name : Laiduhawmi Husband's Name : Lalramhluna House Number (Notional) : 41 Age : 58 Gender : Female</p> <p>Photo Available</p>	<p>486</p> <p>LXK0059964</p> <p>Name : Michael Lalthlamuana Father's Name : Lalramhluna Ralte House Number (Notional) : 41 Age : 39 Gender : Male</p> <p>Photo Available</p>	<p>487</p> <p>JPQ0146217</p> <p>Name : R. Tiangmawii Husband's Name : Muanthanga Tonsing House Number (Notional) : 41 Age : 36 Gender : Female</p> <p>Photo Available</p>
<p>488</p> <p>LXK0057562</p> <p>Name : Thangsanga Father's Name : Zahnuna (L) House Number (Notional) : 42 Age : 73 Gender : Male</p> <p>Photo Available</p>	<p>489</p> <p>LXK0055244</p> <p>Name : K. Lalramhmuaki Husband's Name : Zathangpuia House Number (Notional) : 42 Age : 43 Gender : Female</p> <p>Photo Available</p>	<p>490</p> <p>LXK0042218</p> <p>Name : Zathangpuia Father's Name : Thangsanga House Number (Notional) : 42 Age : 42 Gender : Male</p> <p>Photo Available</p>
<p>491</p> <p>LXK0055806</p> <p>Name : Lalbiaknunga Father's Name : Thangsanga House Number (Notional) : 42 Age : 40 Gender : Male</p> <p>Photo Available</p>	<p>492</p> <p>JDF0315184</p> <p>Name : Saizampuii Sailo Father's Name : Laldinpuia House Number (Notional) : 42 Age : 35 Gender : Female</p> <p>Photo Available</p>	<p>493</p> <p>LXK0212969</p> <p>Name : Lalhimpuii Father's Name : Thangsanga House Number (Notional) : 42 Age : 33 Gender : Female</p> <p>Photo Available</p>
<p>494</p> <p>LXK0244715</p> <p>Name : Lalitanzovi Father's Name : Thangsanga House Number (Notional) : 42 Age : 29 Gender : Female</p> <p>Photo Available</p>	<p>495</p> <p>LXK0057364</p> <p>Name : Zawngnemi Husband's Name : T. Kiamlova House Number (Notional) : 43 Age : 70 Gender : Female</p> <p>Photo Available</p>	<p>496</p> <p>LXK0056036</p> <p>Name : T. Kiamlova Father's Name : Thangchhinga House Number (Notional) : 43 Age : 68 Gender : Male</p> <p>Photo Available</p>
<p>497</p> <p>LXK0055749</p> <p>Name : Lalthangmawii Father's Name : T. Kiamlova House Number (Notional) : 43 Age : 43 Gender : Female</p> <p>Photo Available</p>	<p>498</p> <p>RHE0082412</p> <p>Name : Lalramengmawia Father's Name : Lalrinliana House Number (Notional) : 43 Age : 23 Gender : Male</p> <p>Photo Available</p>	<p>499</p> <p>LXK0055301</p> <p>Name : H. Lalropuia Father's Name : H. Pakunga House Number (Notional) : 44 Age : 51 Gender : Male</p> <p>Photo Available</p>
<p>500</p> <p>LXK0057380</p> <p>Name : Lalremruati Husband's Name : H. Lalropuia House Number (Notional) : 44 Age : 47 Gender : Female</p> <p>Photo Available</p>	<p>501</p> <p>RHE0048439</p> <p>Name : Lalnunmawia Father's Name : Lalropuia House Number (Notional) : 44 Age : 28 Gender : Male</p> <p>Photo Available</p>	<p>502</p> <p>RHE0058693</p> <p>Name : Zarzokima Father's Name : H. Lalropuia House Number (Notional) : 44 Age : 27 Gender : Male</p> <p>Photo Available</p>
<p>503</p> <p>RHE0070805</p> <p>Name : Vanlaruata Father's Name : Lalropuia House Number (Notional) : 44 Age : 24 Gender : Male</p> <p>Photo Available</p>	<p>504</p> <p>RHE0086405</p> <p>Name : Lalhmingmawia Father's Name : Lalropuia House Number (Notional) : 44 Age : 22 Gender : Male</p> <p>Photo Available</p>	<p>505</p> <p>LXK0132209</p> <p>Name : H. V. Lalrindiki Husband's Name : Lalawmpuia Sailo House Number (Notional) : 45 Age : 41 Gender : Female</p> <p>Photo Available</p>
<p>506</p> <p>LXK0055129</p> <p>Name : Lalruatkima Sailo Father's Name : M. Lallura House Number (Notional) : 45 Age : 38 Gender : Male</p> <p>Photo Available</p>	<p>507</p> <p>LXK0055418</p> <p>Name : Lalawmpuia Sailo Father's Name : M. Lallura House Number (Notional) : 45 Age : 37 Gender : Male</p> <p>Photo Available</p>	<p>508</p> <p>LXK0055632</p> <p>Name : C. Lalrinhlua Father's Name : Lalrosanga House Number (Notional) : 46 Age : 45 Gender : Male</p> <p>Photo Available</p>
<p>509</p> <p>BPD0172981</p> <p>Name : Malsawmzuail Husband's Name : C. Lalrinhlua House Number (Notional) : 46 Age : 40 Gender : Female</p> <p>Photo Available</p>	<p>510</p> <p>DPC0030817</p> <p>Name : Lalramhluii Sailo Father's Name : Lalsiamliana Sailo House Number (Notional) : 47 Age : 55 Gender : Female</p> <p>Photo Available</p>	<p>511</p> <p>RHE0029827</p> <p>Name : Rosie N. Lalthanthangi Mother's Name : Lalramhluii Sailo House Number (Notional) : 47 Age : 30 Gender : Female</p> <p>Photo Available</p>

<p>512</p> <p>RHE0037457</p> <p>Name : Cecilia N. Lalhanzami Father's Name : N. Malsawmthanga House Number (Notional) : 47 Age : 29 Gender : Female</p> <p>Photo Available</p>	<p>513</p> <p>RHE0058719</p> <p>Name : Remruatpuii Mother's Name : Lalramhlui Sailo House Number (Notional) : 47 Age : 26 Gender : Female</p> <p>Photo Available</p>	<p>514</p> <p>RHE0070813</p> <p>Name : Nuzawnpuii Mother's Name : Lalramhlui Sailo House Number (Notional) : 47 Age : 24 Gender : Female</p> <p>Photo Available</p>
<p>515</p> <p>LXK0057695</p> <p>Name : Chalhnuna Father's Name : Kaphranga House Number (Notional) : 48 Age : 86 Gender : Male</p> <p>Photo Available</p>	<p>516</p> <p>LXK0042457</p> <p>Name : H. C. Lalhansiami Father's Name : Chalhnuna House Number (Notional) : 48 Age : 45 Gender : Female</p> <p>Photo Available</p>	<p>517</p> <p>LXK0213132</p> <p>Name : H. C. Lalduhzuali Father's Name : H. C. Lalchhariana (L) House Number (Notional) : 48 Age : 38 Gender : Female</p> <p>Photo Available</p>
<p>518</p> <p>RHE0063461</p> <p>Name : Jeffrey Lalawmkima Father's Name : C. Lalrinmawia House Number (Notional) : 48 Age : 25 Gender : Male</p> <p>Photo Available</p>	<p>519</p> <p>LXK0095281</p> <p>Name : P. C. Zoramliana Father's Name : Lalrimingthanga (L) House Number (Notional) : 49 Age : 74 Gender : Male</p> <p>Photo Available</p>	<p>520</p> <p>LXK0095299</p> <p>Name : Lalrindiki Husband's Name : P. C. Zoramliana House Number (Notional) : 49 Age : 54 Gender : Female</p> <p>Photo Available</p>
<p>521</p> <p>LXK0255620</p> <p>Name : P. C. Lalmuankima Father's Name : P. C. Zoramliana House Number (Notional) : 49 Age : 39 Gender : Male</p> <p>Photo Available</p>	<p>522</p> <p>LXK0255653</p> <p>Name : Lalchhanchhuahi Father's Name : Thanluaia House Number (Notional) : 49 Age : 34 Gender : Female</p> <p>Photo Available</p>	<p>523</p> <p>RHE0011643</p> <p>Name : Lalramdinpuia Father's Name : P. C. Zoramliana House Number (Notional) : 49 Age : 33 Gender : Male</p> <p>Photo Available</p>
<p>524</p> <p>RHE0037440</p> <p>Name : Vanlalawmpuii Husband's Name : R. Thanchungnunga House Number (Notional) : 49 Age : 32 Gender : Female</p> <p>Photo Available</p>	<p>525</p> <p>LXK0213173</p> <p>Name : Lalhlamuana Father's Name : Hranghnuna House Number (Notional) : 50 Age : 48 Gender : Male</p> <p>Photo Available</p>	<p>526</p> <p>LXK0213165</p> <p>Name : Zomuanpuii Husband's Name : Lalhlamuana House Number (Notional) : 50 Age : 45 Gender : Female</p> <p>Photo Available</p>
<p>527</p> <p>RHE0058727</p> <p>Name : Lalawmpuii Father's Name : Lalhlamuana House Number (Notional) : 50 Age : 27 Gender : Female</p> <p>Photo Available</p>	<p>528</p> <p>RHE0063487</p> <p>Name : Lalhmangaihzuali Father's Name : Lalhlamuana House Number (Notional) : 50 Age : 25 Gender : Female</p> <p>Photo Available</p>	<p>529</p> <p>RHE0093476</p> <p>Name : Zonunsangi Father's Name : Lalhlamuana House Number (Notional) : 50 Age : 21 Gender : Female</p> <p>Photo Available</p>
<p>530</p> <p>LXK0055038</p> <p>Name : C. Lungmuana Father's Name : Hrangkhuma (L) House Number (Notional) : 51 Age : 81 Gender : Male</p> <p>Photo Available</p>	<p>531</p> <p>LXK0056515</p> <p>Name : Lalvuani Husband's Name : C. Lungmuana House Number (Notional) : 51 Age : 72 Gender : Female</p> <p>Photo Available</p>	<p>532</p> <p>JTB0032433</p> <p>Name : C. Lalnunmawia Father's Name : C. Lungmuana House Number (Notional) : 51 Age : 52 Gender : Male</p> <p>Photo Available</p>
<p>533</p> <p>LXK0055517</p> <p>Name : C. Lalchhuanmawia Father's Name : C. Lungmuana House Number (Notional) : 51 Age : 49 Gender : Male</p> <p>Photo Available</p>	<p>534</p> <p>LXK0056093</p> <p>Name : C. Lalngaihzuali Father's Name : C. Lungmuana House Number (Notional) : 51 Age : 46 Gender : Female</p> <p>Photo Available</p>	<p>535</p> <p>RHE0058685</p> <p>Name : Ramdinsangi Father's Name : C. Lalnoela House Number (Notional) : 51 Age : 26 Gender : Female</p> <p>Photo Available</p>
<p>536</p> <p>CDN0002279</p> <p>Name : Lalhanzami Husband's Name : Lalmawia House Number (Notional) : 52 Age : 86 Gender : Female</p> <p>Photo Available</p>	<p>537</p> <p>RHE0053017</p> <p>Name : Bol Bahadur Father's Name : Indra Badur House Number (Notional) : 53 Age : 39 Gender : Male</p> <p>Photo Available</p>	<p>538</p> <p>RHE0053009</p> <p>Name : Babu Rama Father's Name : Indra Badur House Number (Notional) : 53 Age : 34 Gender : Male</p> <p>Photo Available</p>
<p>539</p> <p>RHE0052993</p> <p>Name : Chandra Bhadur Father's Name : Indra Bhadur House Number (Notional) : 53 Age : 32 Gender : Male</p> <p>Photo Available</p>	<p>540</p> <p>LXK0055509</p> <p>Name : F. Lalsawmliana Father's Name : Hranglinga (L) House Number (Notional) : 54 Age : 61 Gender : Male</p> <p>Photo Available</p>	<p>541</p> <p>LXK0057646</p> <p>Name : Vanrengpuii Husband's Name : F. Lalsawmliana House Number (Notional) : 54 Age : 53 Gender : Female</p> <p>Photo Available</p>

<p>542</p> <p>TXB0038745</p> <p>Name : Lalduhawmi Mother's Name : Laldawngliani House Number (Notional) : 54 Age : 31 Gender : Female</p> <p>Photo Available</p>	<p>543</p> <p>LXK0255828</p> <p>Name : Zothantluanga Father's Name : F. Lalsawmliana House Number (Notional) : 54 Age : 29 Gender : Male</p> <p>Photo Available</p>	<p>544</p> <p>RHE0029868</p> <p>Name : Lalmuanpuia Father's Name : F. Lalsawmliana House Number (Notional) : 54 Age : 30 Gender : Male</p> <p>Photo Available</p>
<p>545</p> <p>RHE0048470</p> <p>Name : Laiduhzuali Father's Name : F. Lalsawmliana House Number (Notional) : 54 Age : 28 Gender : Female</p> <p>Photo Available</p>	<p>546</p> <p>RHE0054098</p> <p>Name : F. Lalchhanhimi Father's Name : F. Sangthanga House Number (Notional) : 54 Age : 27 Gender : Female</p> <p>Photo Available</p>	<p>547</p> <p>RHE0070821</p> <p>Name : Lalrinawma Father's Name : F. Lalsawmliana House Number (Notional) : 54 Age : 24 Gender : Male</p> <p>Photo Available</p>
<p>548</p> <p>LXK0155416</p> <p>Name : Rualchhinga Father's Name : Bawithanga (L) House Number (Notional) : 55 Age : 63 Gender : Male</p> <p>Photo Available</p>	<p>549</p> <p>LXK0055178</p> <p>Name : H. S. Lalchhuanawma Father's Name : Lalthuamluaia House Number (Notional) : 56 Age : 50 Gender : Male</p> <p>Photo Available</p>	<p>550</p> <p>LXK0055186</p> <p>Name : K Laitlanthangi Husband's Name : H. S. Lalchhuanawma House Number (Notional) : 56 Age : 46 Gender : Female</p> <p>Photo Available</p>
<p>551</p> <p>RHE0082503</p> <p>Name : Lalruatsangi Father's Name : H. S. Lalchhuanawma House Number (Notional) : 56 Age : 23 Gender : Female</p> <p>Photo Available</p>	<p>552</p> <p>RHE0093492</p> <p>Name : Lalmawizuali Father's Name : Lalchhuanawma House Number (Notional) : 56 Age : 21 Gender : Female</p> <p>Photo Available</p>	<p>553</p> <p>LXK0095364</p> <p>Name : J. Dosanga Father's Name : Suaka (L) House Number (Notional) : 57 Age : 57 Gender : Male</p> <p>Photo Available</p>
<p>554</p> <p>LXK0057463</p> <p>Name : Hrangchuallovi Husband's Name : J. Dosanga House Number (Notional) : 57 Age : 57 Gender : Female</p> <p>Photo Available</p>	<p>555</p> <p>CBM0207308</p> <p>Name : R. Lalmalsawmkimi Husband's Name : Lalmuanpuia House Number (Notional) : 57 Age : 36 Gender : Female</p> <p>Photo Available</p>	<p>556</p> <p>LXK0255786</p> <p>Name : Lalmuanpuia Father's Name : J. Dosanga House Number (Notional) : 57 Age : 34 Gender : Male</p> <p>Photo Available</p>
<p>557</p> <p>LXK0056317</p> <p>Name : J. Lalngaihawmi Father's Name : J. Dosanga House Number (Notional) : 58 Age : 39 Gender : Female</p> <p>Photo Available</p>	<p>558</p> <p>LXK0055889</p> <p>Name : Rothianga Zote Father's Name : Lalrova House Number (Notional) : 59 Age : 59 Gender : Male</p> <p>Photo Available</p>	<p>559</p> <p>LXK0056531</p> <p>Name : Lalmuankima Father's Name : Rothianga Zote House Number (Notional) : 59 Age : 41 Gender : Male</p> <p>Photo Available</p>
<p>560</p> <p>RHE0048496</p> <p>Name : K. Lalramdinthara Father's Name : K. Lalrinpuia House Number (Notional) : 59 Age : 28 Gender : Male</p> <p>Photo Available</p>	<p>561</p> <p>LHM0205906</p> <p>Name : R. Lallungmuana Father's Name : M. S. Dawngliana House Number (Notional) : 60 Age : 39 Gender : Male</p> <p>Photo Available</p>	<p>562</p> <p>LXK0212894</p> <p>Name : Lalchhandami Father's Name : Rothianga Zote House Number (Notional) : 60 Age : 33 Gender : Female</p> <p>Photo Available</p>
<p>563</p> <p>LXK0055103</p> <p>Name : F. Zakhuma Father's Name : Selhnuna House Number (Notional) : 61 Age : 68 Gender : Male</p> <p>Photo Available</p>	<p>564</p> <p>LXK0056770</p> <p>Name : Lalchuangkimi Husband's Name : F. Zakhuma House Number (Notional) : 61 Age : 64 Gender : Female</p> <p>Photo Available</p>	<p>565</p> <p>LXK0059741</p> <p>Name : F. Lalhlira Father's Name : Selhnuna House Number (Notional) : 62 Age : 64 Gender : Male</p> <p>Photo Available</p>
<p>566</p> <p>LXK0059758</p> <p>Name : Vanialuapi Husband's Name : F. Lalhlira House Number (Notional) : 62 Age : 61 Gender : Female</p> <p>Photo Available</p>	<p>567</p> <p>RHE0024182</p> <p>Name : Lalmuanchhana Fanai Father's Name : F. Lalhlira House Number (Notional) : 62 Age : 31 Gender : Male</p> <p>Photo Available</p>	<p>568</p> <p>LXK0235663</p> <p>Name : Lalrawngbawli Fanai Father's Name : F. Lalhlira House Number (Notional) : 62 Age : 29 Gender : Female</p> <p>Photo Available</p>
<p>569</p> <p>RHE0048413</p> <p>Name : Ruth Lalhrualtuangi Father's Name : F. Lalhlira House Number (Notional) : 62 Age : 28 Gender : Female</p> <p>Photo Available</p>	<p>570</p> <p>LXK0057448</p> <p>Name : Lalzamliani Husband's Name : Lalzawmliana (L) House Number (Notional) : 63 Age : 66 Gender : Female</p> <p>Photo Available</p>	<p>571</p> <p>JTB0109157</p> <p>Name : F. Malsawmtluangi Husband's Name : Lalremliana House Number (Notional) : 63 Age : 44 Gender : Female</p> <p>Photo Available</p>

<p>572</p> <p>LXK0055574</p> <p>Name : Lalremliana Father's Name : Lalzawmliana (L) House Number (Notional) : 63 Age : 43 Gender : Male</p> <p>Photo</p> <p>Available</p>	<p>573</p> <p>LXK0056408</p> <p>Name : Zonunpari Father's Name : Lalzawmliana (L) House Number (Notional) : 63 Age : 39 Gender : Female</p> <p>Photo</p> <p>Available</p>	<p>574</p> <p>KDJ0139907</p> <p>Name : Zatiuangi Husband's Name : Zungthanga House Number (Notional) : 64 Age : 70 Gender : Female</p> <p>Photo</p> <p>Available</p>
<p>575</p> <p>MYL0006965</p> <p>Name : Lalkhumsangi Husband's Name : Lalmalsawma House Number (Notional) : 64 Age : 50 Gender : Female</p> <p>Photo</p> <p>Available</p>	<p>576</p> <p>KDJ0139923</p> <p>Name : Lalmalsawma Father's Name : Zungthanga House Number (Notional) : 64 Age : 42 Gender : Male</p> <p>Photo</p> <p>Available</p>	<p>577</p> <p>RHE0069260</p> <p>Name : Lalramnghaka Father's Name : Hmingthanmawia House Number (Notional) : 64 Age : 27 Gender : Male</p> <p>Photo</p> <p>Available</p>
<p>578</p> <p>RHE0069278</p> <p>Name : Lalhmingmawia Father's Name : Hmingthanmawia House Number (Notional) : 64 Age : 26 Gender : Male</p> <p>Photo</p> <p>Available</p>	<p>579</p> <p>RHE0037549</p> <p>Name : Lalduhawmi Husband's Name : K. Lalhriatpuia House Number (Notional) : 65 Age : 31 Gender : Female</p> <p>Photo</p> <p>Available</p>	<p>580</p> <p>TXU0002220</p> <p>Name : K. Lalhriatpuia Father's Name : K. Zachhunga (L) House Number (Notional) : 65 Age : 31 Gender : Male</p> <p>Photo</p> <p>Available</p>
<p>581</p> <p>LXK0042267</p> <p>Name : Hmingthanmawia Father's Name : Rochhinga (L) House Number (Notional) : 66 Age : 70 Gender : Male</p> <p>Photo</p> <p>Available</p>	<p>582</p> <p>LXK0057349</p> <p>Name : Lalramnghaka Father's Name : Rochhinga (L) House Number (Notional) : 66 Age : 49 Gender : Male</p> <p>Photo</p> <p>Available</p>	<p>583</p> <p>LXK0057455</p> <p>Name : Vanneihl Husband's Name : Lalramnghaka House Number (Notional) : 66 Age : 41 Gender : Female</p> <p>Photo</p> <p>Available</p>
<p>584</p> <p>RHE0052860</p> <p>Name : Lalchuanmawii Father's Name : Lalramnghaka House Number (Notional) : 66 Age : 27 Gender : Female</p> <p>Photo</p> <p>Available</p>	<p>585</p> <p>RHE0086421</p> <p>Name : Vanlalthruaitluanga Father's Name : Lalramnghaka House Number (Notional) : 66 Age : 23 Gender : Male</p> <p>Photo</p> <p>Available</p>	<p>586</p> <p>LXK0056226</p> <p>Name : Rualkunga Father's Name : Laisuaka (L) House Number (Notional) : 67 Age : 53 Gender : Male</p> <p>Photo</p> <p>Available</p>
<p>587</p> <p>LXK0056176</p> <p>Name : Thangliani Husband's Name : Rualkunga House Number (Notional) : 67 Age : 54 Gender : Female</p> <p>Photo</p> <p>Available</p>	<p>588</p> <p>LXK0056150</p> <p>Name : Lalchawimawia Father's Name : Rualkunga House Number (Notional) : 67 Age : 38 Gender : Male</p> <p>Photo</p> <p>Available</p>	<p>589</p> <p>CBM0206698</p> <p>Name : Dorothy Lalmanpuui Father's Name : Thansiamia Royte House Number (Notional) : 67 Age : 37 Gender : Female</p> <p>Photo</p> <p>Available</p>
<p>590</p> <p>LXK0056143</p> <p>Name : Lalmuanpuia Father's Name : Rualkunga House Number (Notional) : 67 Age : 37 Gender : Male</p> <p>Photo</p> <p>Available</p>	<p>591</p> <p>LXK0212852</p> <p>Name : V. Lalrindika Father's Name : V. Rualkunga House Number (Notional) : 67 Age : 32 Gender : Male</p> <p>Photo</p> <p>Available</p>	<p>592</p> <p>LXK0255752</p> <p>Name : Lalduhsangi Father's Name : Rualkunga House Number (Notional) : 67 Age : 29 Gender : Female</p> <p>Photo</p> <p>Available</p>
<p>593</p> <p>LXK0056168</p> <p>Name : V. Laithakima Father's Name : Rualkunga House Number (Notional) : 68 Age : 43 Gender : Male</p> <p>Photo</p> <p>Available</p>	<p>594</p> <p>RHE0011726</p> <p>Name : Hmingthansangi Father's Name : T. C. Lalchhanchhuaha House Number (Notional) : 68 Age : 30 Gender : Female</p> <p>Photo</p> <p>Available</p>	<p>595</p> <p>LXK0057299</p> <p>Name : Lalmuanpuia Father's Name : Rochhinga (L) House Number (Notional) : 69 Age : 52 Gender : Male</p> <p>Photo</p> <p>Available</p>
<p>596</p> <p>RHE0052878</p> <p>Name : Lalrotluanga Father's Name : Lalmuanpuia House Number (Notional) : 69 Age : 27 Gender : Male</p> <p>Photo</p> <p>Available</p>	<p>597</p> <p>LXK0213025</p> <p>Name : Lalhriatpuui Husband's Name : Lalrinnunga House Number (Notional) : 70 Age : 34 Gender : Female</p> <p>Photo</p> <p>Available</p>	<p>598</p> <p>LXK0213017</p> <p>Name : Lalrinnunga Father's Name : P. Lala House Number (Notional) : 70 Age : 33 Gender : Male</p> <p>Photo</p> <p>Available</p>
<p>599</p> <p>LXK0212902</p> <p>Name : Vanlalpeki Father's Name : P. Lala House Number (Notional) : 70 Age : 32 Gender : Female</p> <p>Photo</p> <p>Available</p>	<p>600</p> <p>RHE0068775</p> <p>Name : Lalruatfeli Father's Name : P. Lala House Number (Notional) : 70 Age : 25 Gender : Female</p> <p>Photo</p> <p>Available</p>	<p>601</p> <p>KDJ0138065</p> <p>Name : Neiththangi Father's Name : Puia House Number (Notional) : 71 Age : 74 Gender : Female</p> <p>Photo</p> <p>Available</p>

<p>602</p> <p>Name : Thangpuii Father's Name : Puia (L) House Number (Notional) : 71 Age : 55 Gender : Female</p> <p>Photo Available</p>	LXK0057422	<p>603</p> <p>Name : Ramzauvi Husband's Name : Thanghnuna House Number (Notional) : 72 Age : 65 Gender : Female</p> <p>Photo Available</p>	LXK0057620	<p>604</p> <p>Name : Lalbiakmawii Father's Name : Thanghnuna House Number (Notional) : 72 Age : 41 Gender : Female</p> <p>Photo Available</p>	LXK0056705
<p>605</p> <p>Name : Lalthanmawii Father's Name : Thanghnuna House Number (Notional) : 72 Age : 40 Gender : Female</p> <p>Photo Available</p>	LXK0255638	<p>606</p> <p>Name : Laingaihawmi Father's Name : Thanghnuna House Number (Notional) : 72 Age : 39 Gender : Female</p> <p>Photo Available</p>	LXK0059915	<p>607</p> <p>Name : Lalthiamuana Father's Name : Thanghnuna House Number (Notional) : 72 Age : 34 Gender : Male</p> <p>Photo Available</p>	LXK0249078
<p>608</p> <p>Name : Lalhminghlui Father's Name : Thanghnuna House Number (Notional) : 72 Age : 32 Gender : Female</p> <p>Photo Available</p>	LXK0213306	<p>609</p> <p>Name : Lalchhuanvawra Father's Name : Thanghnuna House Number (Notional) : 73 Age : 38 Gender : Male</p> <p>Photo Available</p>	LXK0057398	<p>610</p> <p>Name : Malsawmdawngzeli Husband's Name : Lalchhuanvawra House Number (Notional) : 73 Age : 35 Gender : Female</p> <p>Photo Available</p>	LXK0255661
<p>611</p> <p>Name : Ngurhmingthanga Father's Name : Hranghleia (L) House Number (Notional) : 74 Age : 44 Gender : Male</p> <p>Photo Available</p>	LXK0171348	<p>612</p> <p>Name : H. Chungnungi Husband's Name : Ngurhmingthanga House Number (Notional) : 74 Age : 43 Gender : Female</p> <p>Photo Available</p>	LXK0171355	<p>613</p> <p>Name : Lalchhuansangi Father's Name : Ngurhmingthanga House Number (Notional) : 74 Age : 22 Gender : Female</p> <p>Photo Available</p>	RHE0086439
<p>614</p> <p>Name : Hunlawmawmi Husband's Name : T. Lalmalsawma House Number (Notional) : 75 Age : 53 Gender : Female</p> <p>Photo Available</p>	LXK0095323	<p>615</p> <p>Name : T. Lalmalsawma Father's Name : T. Lalhmingthanga House Number (Notional) : 75 Age : 50 Gender : Male</p> <p>Photo Available</p>	LXK0055137	<p>616</p> <p>Name : Tc Lalrinchhungi Father's Name : T. Lalmalsawma House Number (Notional) : 75 Age : 35 Gender : Female</p> <p>Photo Available</p>	LXK0244889
<p>617</p> <p>Name : Cicilia Lalnunsangi Father's Name : T. Lalmalsawma House Number (Notional) : 75 Age : 32 Gender : Female</p> <p>Photo Available</p>	RHE0020347	<p>618</p> <p>Name : Kapkunga Mother's Name : Lalawmi House Number (Notional) : 76 Age : 55 Gender : Male</p> <p>Photo Available</p>	BPD0299644	<p>619</p> <p>Name : J. H. Lalramchuana Father's Name : Sanglawma (L) House Number (Notional) : 77 Age : 41 Gender : Male</p> <p>Photo Available</p>	LXK0232983
<p>620</p> <p>Name : H. Lalramghaki Husband's Name : J. H. Lalramchuana House Number (Notional) : 77 Age : 37 Gender : Female</p> <p>Photo Available</p>	LXK0057588	<p>621</p> <p>Name : Zion Lalramhluna Father's Name : J. H. Lalramchuana House Number (Notional) : 77 Age : 23 Gender : Male</p> <p>Photo Available</p>	RHE0082867	<p>622</p> <p>Name : Vanlalmalsawmkima Father's Name : J.H. Lalramchuana House Number (Notional) : 77 Age : 21 Gender : Male</p> <p>Photo Available</p>	RHE0093500
<p>623</p> <p>Name : Lalrintluanga Zote Father's Name : J.H. Lalramchuana House Number (Notional) : 77 Age : 19 Gender : Male</p> <p>Photo Available</p>	RHE0112664	<p>624</p> <p>Name : Hmunthangi Father's Name : Thanthuama House Number (Notional) : 78 Age : 44 Gender : Female</p> <p>Photo Available</p>	MYT0040048	<p>625</p> <p>Name : Lalthanpuii Father's Name : Thatinchhuma House Number (Notional) : 78 Age : 44 Gender : Female</p> <p>Photo Available</p>	YGS0019133
<p>626</p> <p>Name : Sangkungi Mother's Name : Hranghnuni House Number (Notional) : 78 Age : 37 Gender : Female</p> <p>Photo Available</p>	MYT0040253	<p>627</p> <p>Name : Malsawmdawngzela Mother's Name : Hranghnuni House Number (Notional) : 78 Age : 34 Gender : Male</p> <p>Photo Available</p>	YGS0010157	<p>628</p> <p>Name : Dengchhungi Husband's Name : Thanhlira House Number (Notional) : 79 Age : 74 Gender : Female</p> <p>Photo Available</p>	BPD0014555
<p>629</p> <p>Name : Thanhlira Father's Name : Hrangkima House Number (Notional) : 79 Age : 69 Gender : Male</p> <p>Photo Available</p>	BPD0028597	<p>630</p> <p>Name : Lalchhandama Father's Name : Thanhlira House Number (Notional) : 79 Age : 21 Gender : Male</p> <p>Photo Available</p>	RHE0101907	<p>631</p> <p>Name : Lalbiakthara Father's Name : Pahlira House Number (Notional) : 80 Age : 59 Gender : Male</p> <p>Photo Available</p>	LXK0213124

<p>632</p> <p>LXK0056564</p> <p>Name : Lalengzami Father's Name : Rothangvunga House Number (Notional) : 81 Age : 53 Gender : Female</p> <p>Photo</p> <p>Available</p>	<p>633</p> <p>FDV0126029</p> <p>Name : Vanthangmawia Father's Name : Laltana House Number (Notional) : 83 Age : 42 Gender : Male</p> <p>Photo</p> <p>Available</p>	<p>634</p> <p>FDV0175125</p> <p>Name : Lalringgehti Husband's Name : Vanthangmawia House Number (Notional) : 83 Age : 40 Gender : Female</p> <p>Photo</p> <p>Available</p>
<p>635</p> <p>MYT0168062</p> <p>Name : Biakmuani Husband's Name : Lalkhuma House Number (Notional) : 84 Age : 43 Gender : Female</p> <p>Photo</p> <p>Available</p>	<p>636</p> <p>YGS0059519</p> <p>Name : Lalhruaimawii Mother's Name : Biakmuani House Number (Notional) : 84 Age : 24 Gender : Female</p> <p>Photo</p> <p>Available</p>	<p>637</p> <p>RHE0102087</p> <p>Name : Vanlaimawii Mother's Name : Biakmuani House Number (Notional) : 84 Age : 20 Gender : Female</p> <p>Photo</p> <p>Available</p>
<p>638</p> <p>RHE0112656</p> <p>Name : Joseph Lalpekthanga Mother's Name : Biakmuani House Number (Notional) : 84 Age : 19 Gender : Male</p> <p>Photo</p> <p>Available</p>	<p>639</p> <p>MRS0020404</p> <p>Name : K.C. Lalzamliani Husband's Name : F.Vanlaimawii House Number (Notional) : 85 Age : 46 Gender : Female</p> <p>Photo</p> <p>Available</p>	<p>640</p> <p>XOD0058131</p> <p>Name : F.Vanlaimawii Father's Name : F.Larchhuakmawia House Number (Notional) : 85 Age : 42 Gender : Male</p> <p>Photo</p> <p>Available</p>
<p>641</p> <p>RHE0108290</p> <p>Name : F Vanlaidampui Father's Name : F Vanlaimawii House Number (Notional) : 85 Age : 19 Gender : Female</p> <p>Photo</p> <p>Available</p>	<p>642</p> <p>CDN0002311</p> <p>Name : C. Zaidingpui Husband's Name : H. Lalpiangmawia House Number (Notional) : 86 Age : 59 Gender : Female</p> <p>Photo</p> <p>Available</p>	<p>643</p> <p>CDN0002303</p> <p>Name : H. Lalpiangmawia Father's Name : Chalhuna House Number (Notional) : 86 Age : 56 Gender : Male</p> <p>Photo</p> <p>Available</p>
<p>644</p> <p>TXB0049866</p> <p>Name : H. Vanlalinguri Father's Name : H. Lalpiangmawia House Number (Notional) : 86 Age : 28 Gender : Female</p> <p>Photo</p> <p>Available</p>	<p>645</p> <p>TXB0053660</p> <p>Name : Alex H. Lalratfela Father's Name : H. Lalpiangmawia House Number (Notional) : 86 Age : 26 Gender : Male</p> <p>Photo</p> <p>Available</p>	<p>646</p> <p>TYI0021303</p> <p>Name : Lalhmingsangi Father's Name : F. Kawiramthanga (L) House Number (Notional) : 87 Age : 32 Gender : Female</p> <p>Photo</p> <p>Available</p>
<p>647</p> <p>RHE0114512</p> <p>Name : Ruthi Lalrinkimi Mother's Name : C Lalinghual House Number (Notional) : 51 Age : 18 Gender : Female</p> <p>Photo</p> <p>Available</p>	<p>648</p> <p>RHE0115576</p> <p>Name : R Lalhlamuana Father's Name : Lalpakawma House Number (Notional) : 21 Age : 18 Gender : Male</p> <p>Photo</p> <p>Available</p>	<p>649</p> <p>RHE0117283</p> <p>Name : RK Lalrinawma Father's Name : Jerry Lalriliana House Number (Notional) : 4 Age : 18 Gender : Male</p> <p>Photo</p> <p>Available</p>
<p>650</p> <p>RHE0117648</p> <p>Name : Irene Lalduhmawii Mother's Name : C Zingengmawii House Number (Notional) : 14 Age : 18 Gender : Female</p> <p>Photo</p> <p>Available</p>	<p>651</p> <p>RHE0117671</p> <p>Name : Joel Zothansanga Father's Name : JH Lalramchuana House Number (Notional) : 77 Age : 18 Gender : Male</p> <p>Photo</p> <p>Available</p>	<p>652</p> <p>RHE0117689</p> <p>Name : Jenny Lalmuankimi Father's Name : Lalmlasawma House Number (Notional) : 64 Age : 18 Gender : Female</p> <p>Photo</p> <p>Available</p>
<p>653</p> <p>TYI1331917</p> <p>Name : JOEL LALTHANZUALA Father's Name : LALTHANSIAMA House Number (Notional) : 68 Age : 21 Gender : Male</p> <p>Photo</p> <p>Available</p>	<p>654</p> <p>TYI1331891</p> <p>Name : LALTHANTLUANGA Father's Name : LALTHANSIAMA House Number (Notional) : 68 Age : 20 Gender : Male</p> <p>Photo</p> <p>Available</p>	<p>655</p> <p>CVJ4405742</p> <p>Name : shailendra kumar sahani Father's Name : Trilokinath Chaudhari House Number (Notional) : Age : 35 Gender : Male</p> <p>Photo</p> <p>Available</p>
<p>656</p> <p>TAD2416071</p> <p>Name : SRAWAN KUMAR PRASAD Father's Name : AKLU PRASAD House Number (Notional) : Age : 46 Gender : Male</p> <p>Photo</p> <p>Available</p>	<p># 657</p> <p>GJG0643262</p> <p>Name : T Ngaithianhoih Husband's Name : Th. Biaklian House Number (Notional) : Age : 36 Gender : Female</p> <p>Photo</p> <p>Available</p>	<p># 658</p> <p>GJG0539049</p> <p>Name : TH Biaklian Father's Name : Chinzasuan House Number (Notional) : Age : 37 Gender : Male</p> <p>Photo</p> <p>Available</p>
<p>659</p> <p>MRV0278051</p> <p>Name : C Nunvuli Father's Name : CH. Liana House Number (Notional) : 7 Age : 39 Gender : Female</p> <p>Photo</p> <p>Available</p>		

1- List of Additions 1 (06-01-2024 08-02-2024)

<p>660 1 NSM0016865</p> <p>Name : Rebek Lahnunziri Mother's Name: Zahmingthangi House Number (Notional) : 53 Age : 33 Gender : Female</p> <p>Photo Available</p>	<p>661 2 RHE0048520</p> <p>Name : Lalzarmawii Sailo Husband's Name: John Lalchhuansanga House Number (Notional) : 59 Age : 28 Gender : Female</p> <p>Photo Available</p>	<p>662 2 ZNS0008649</p> <p>Name : John Lalchhuansanga Father's Name: LALNEIHTLUANGA House Number (Notional) : 59 Age : 29 Gender : Male</p> <p>Photo Available</p>
<p>663 1 KKD1954569</p> <p>Name : Deshabhakit Marandi Father's Name: Ram Marandi House Number (Notional) : Age : 47 Gender : Male</p> <p>Photo Available</p>	<p>664 2 XOD0052282</p> <p>Name : F Lalhriathlua Father's Name: Lalramhluna House Number (Notional) : 8 Age : 25 Gender : Male</p> <p>Photo Available</p>	<p>665 1 RHE0119420</p> <p>Name : Ngursailova Father's Name: Saizika Sailo House Number (Notional) : 84 Age : 18 Gender : Male</p> <p>Photo Available</p>
<p>666 1 RHE0119917</p> <p>Name : Karan Lalrinawma Father's Name: Uttam Kumar House Number (Notional) : 42 Age : 18 Gender : Male</p> <p>Photo Available</p>	<p>667 1 RHE0119941</p> <p>Name : Arjun Sunar Father's Name: Uttam Kumar House Number (Notional) : 42 Age : 19 Gender : Male</p> <p>Photo Available</p>	<p>668 1 RHE0119990</p> <p>Name : Lalmuanzova Father's Name: H Lalngaihawma House Number (Notional) : 3 Age : 18 Gender : Male</p> <p>Photo Available</p>
<p>669 1 RHE0120006</p> <p>Name : Vanialruatfela Father's Name: K Lalawmpuia House Number (Notional) : 9 Age : 19 Gender : Male</p> <p>Photo Available</p>	<p>670 1 RHE0120014</p> <p>Name : H Lalhruaitluanga Father's Name: H Lalzarliana House Number (Notional) : 69 Age : 19 Gender : Male</p> <p>Photo Available</p>	

SUMMARY OF ELECTORS							
A) NUMBER OF ELECTORS							
		Roll Type	Roll Identification	NUMBER OF ELECTORS			
				Male	Female	Third Gender	Total
I	Mother Roll	Mother Roll	Basic Roll of Intensive Revision, 2005 integrated with all supplements of Special Summary Revision, 2024	316	343	0	659
II	1- List of Additions	List of Additions, Deletions and Corrections done during revision period after Final Roll published in October 2023. These entries have been incorporated in the Integrated Electoral Roll 1	Special Summary Revision 2024	9	2	0	11
III	2- List of Deletions	List of Additions, Deletions and Corrections done during revision period after Final Roll published in	Special Summary Revision 2024	1	1	0	2

		October 2023. These entries have been incorporated in the Integrated Electoral Roll 1				
IV	Difference due to modification in Gender field		0	0	0	0
Net Elector in this Roll after this Revision (I+II-III+IV)			324	344	0	668

B) NUMBER OF MODIFICATIONS

Roll Type	Roll Identification	NUMBER OF MODIFICATIONS
List of Additions, Deletions and Corrections done during revision period after Final Roll published in October 2023. These entries have been incorporated in the Integrated Electoral Roll 1	Special Summary Revision 2024	2

Signature of Electoral Registration Officer

E-Expired S-Shifted/Change of Residence R-Duplicate M-Missing Q-Disqualified